

Property Name	LUMIERE NAKACHO	Unit No.	TYPE	Access	Yuutennji Station on Toyoko Line (11 min) Gakugeidaigaku Station on Toyoko Line (12 min)
		202	Apt.		
Address	2-32-1, Nakacho, Meguro-Ku, Tokyo				

Low-rise Apartment in Nakacho, Accessible to Yutenji

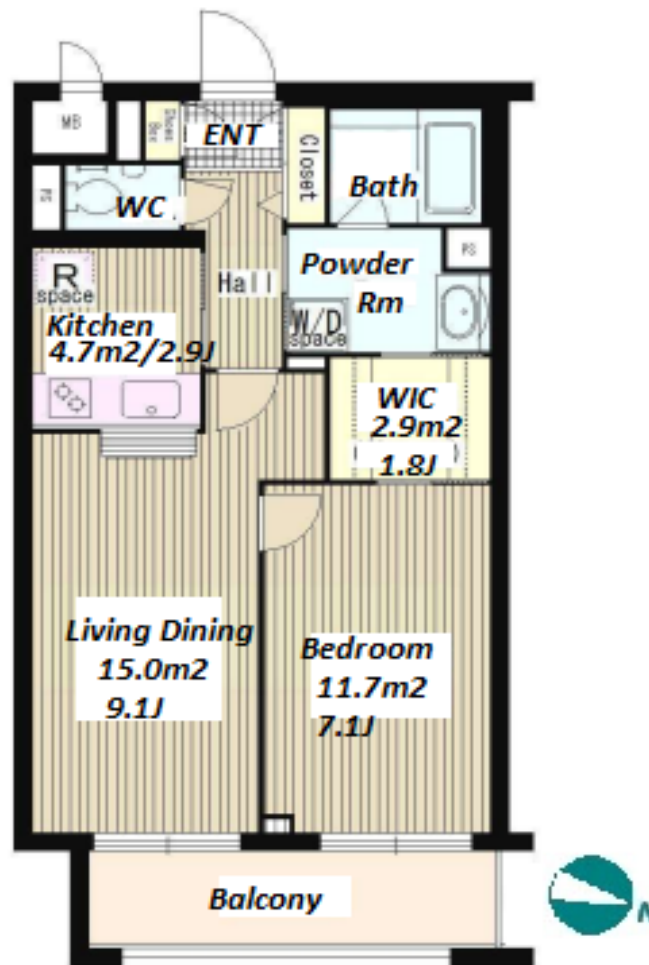

*The actual Layout & Size may differ slightly from this floor plans & pictures.

Lease Conditions			
LAYOUT	1 BR		
SIZE	48.6 m ² /523.12 ft ²		
RENT	JPY 179,000 / month		
Management Fee	JPY10,000/month		
Deposit	2 months	Key Money	1.5 months
Lease Term	Standard lease for 24 months		
Available	End, Jun, 2024		
Renewal Fee	1 month		
Agent Fee	1 month + tax		
Other Info	Key Replacement Fee : JPY20,000 Tax not included / Guarantor Company : TBC / Auto lock / Air-Con / Separated Toilet / Balcony / Penalty Fee for Early Cancellation / Musical Instrument Negotiable / Flooring / Bathroom dryer / WIC		

Building Information			
Completion	May, 2008	Earthquake Resistance	New
Structure	RC, 3 floors above		
Car Parking	N/A		
Bicycle Parking	for 1 space (Included)		
Music Instrument	Negotiable	Pet	-
Facilities	Motorcycle Parking (TBC) / Near Large Parks / Janitor / Delivery box		

Remarks
Renters Insurance : Required



HOUSEREP TOKYO INC.

ハウスレップトーキョー株式会社

#301, 1-4-15, Hiroo, Shibuya-ku, Tokyo 150-0012, Japan

+81 (0)3 6427 5860

inquiry@housserrep-tokyo.com

Transaction Type : Intermediate

Agent Fee : 1 month + tax

Website : www.housserrep-tokyo.com

