

Property Name	PARK AXIS HIGASHI-NIHONBASHI STATION GATE	Unit No.	TYPE	Access	Bakuroyokoyama Station on Toei Shinjuku Line (1 min) Bakurochou Station on JR Sobu Line (2 min)
		605	Apt.		
Address	3-3-10, Higashinihombashi, Chuo-Ku, Tokyo				

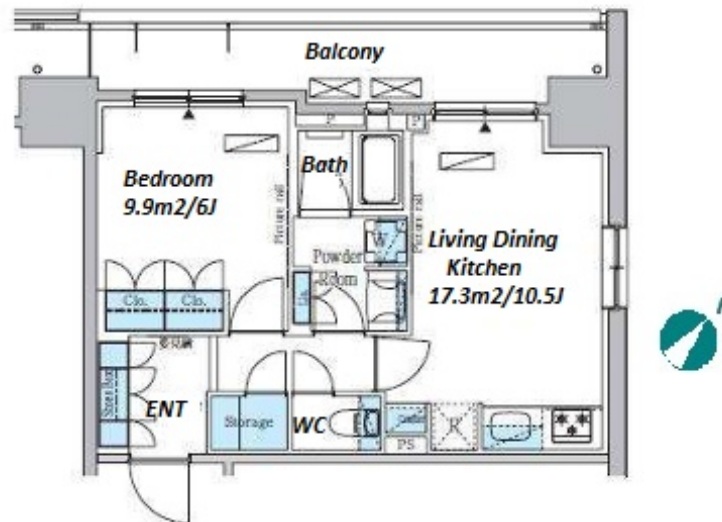

Lease Conditions			
LAYOUT	1 BR		
SIZE	43.04 m ² /463.27 ft ²		
RENT	JPY 199,000 / month		
Management Fee	JPY15,000/month		
Deposit	2 months	Key Money	1 month
Lease Term	Standard lease for 24 months		
Available	End, Jul, 2024		
Renewal Fee	1 month		
Agent Fee	1 month + tax		
Other Info	Key Replacement Fee : JPY20,000 Tax not included / Guarantor Company : TBC / Auto lock / Air-Con / Separated Toilet / Balcony / Musical Instrument Negotiable / CS/CATV / Flooring / Bathroom dryer		

Building Information			
Completion	Apr, 2015	Earthquake Resistance	New
Structure	RC, 14 floors above		
Car Parking	JPY45,000/ month		
Bicycle Parking	for 1 space (Included)		
Music Instrument	Negotiable	Pet	Negotiable
Facilities	Motorcycle Parking (TBC) / Delivery box / Elevator		

Remarks
Renters Insurance : Required

*The actual Layout & Size may differ slightly from this floor plans & pictures.



HOUSEREP TOKYO INC.

ハウスレップトーキョー株式会社

#301, 1-4-15, Hiroo, Shibuya-ku, Tokyo 150-0012, Japan

+81 (0)3 6427 5860

inquiry@housserrep-tokyo.com

Transaction Type : Intermediate

Agent Fee : 1 month + tax

Website : www.housserrep-tokyo.com

