

Property Name	CONFORT TSUKISHIMA	Unit No.	TYPE	Access	Tsukishima Station on Yurakucho Line (4 min) Tsukishima Station on Oedo Line (4 min)
		504	Apt.		
Address	1-10-7, Tsukuda, Chuo-Ku, Tokyo				

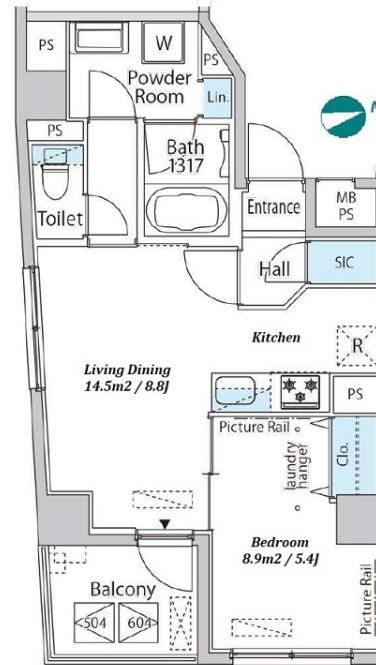

Lease Conditions

LAYOUT	1 BR		
SIZE	40.88 m²/440.02 ft²		
RENT	JPY 177,000 / month		
Management Fee	JPY12,000/month		
Deposit	1 month	Key Money	1.5 months
Lease Term	Standard lease for 24 months		
Available	End, Jun, 2024		
Renewal Fee	1 month		
Agent Fee	1 month + tax		
Other Info	Key Replacement Fee : JPY20,000 Tax not included / Auto lock / Air-Con / Separated Toilet / Balcony / Bathroom dryer / Corner Unit		

Building Information

Completion	Mar, 2022	Earthquake Resistance	New
Structure	RC, 7 floors above		
Car Parking	-		
Bicycle Parking	JPY300 + tax / month		
Music Instrument	-	Pet	
Facilities	Delivery box / Elevator / Close to Station / 24h Garbage Drop-off / Newly-built (~7 y/o)		

Remarks

Renters Insurance : Required / Pet:additional deposit (1 month) / Pet : No Cats

*The actual Layout & Size may differ slightly from this floor plans & pictures.



HOUSEREP TOKYO INC.

ハウズレップトーキョー株式会社

#301, 1-4-15, Hiroo, Shibuya-ku, Tokyo 150-0012, Japan

+81 (0)3 6427 5860

inquiry@housserrep-tokyo.com

Transaction Type : Intermediate

Agent Fee : 1 month + tax

Website : www.housserrep-tokyo.com

