

Property Name	IPSE TSUKISHIMA TOKYO	Unit No.	TYPE	Access	Tsukishima Station on Yurakucho Line (3 min) Tsukishima Station on Oedo Line (3 min)
		703	Apt.		
Address	2-6-1, Tsukuda, Chuo-Ku, Tokyo				

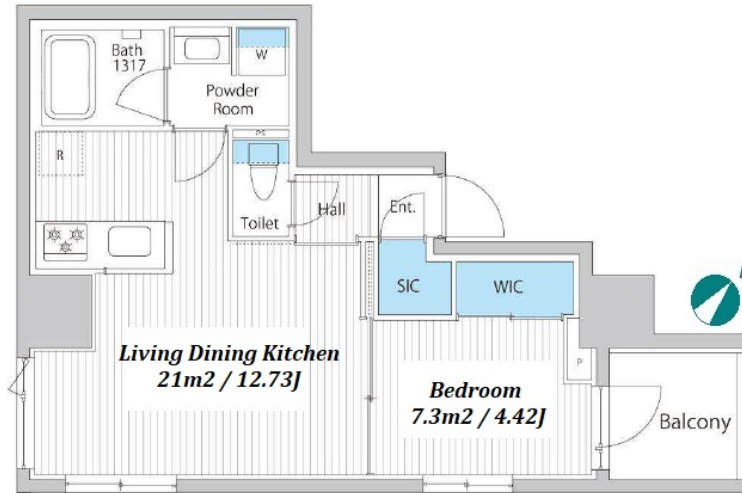
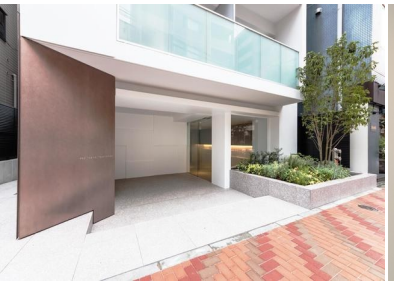

Lease Conditions	
LAYOUT	1 BR
SIZE	40.56 m²/436.58 ft²
RENT	JPY 180,000 / month
Management Fee	JPY15,000/month
Deposit	1 month
Key Money	-
Lease Term	Standard lease for 24 months
Available	Now
Renewal Fee	1 month
Agent Fee	1 month + tax
Other Info	Key Replacement Fee : JPY20,000 Tax not included / No Key Money / Auto lock / Air-Con / Separated Toilet / Balcony / Internet Included / Penalty Fee for Early Cancellation / Flooring / Bathroom dryer / WIC / Corner Unit

Building Information			
Completion	Jul, 2022	Earthquake Resistance	New
Structure	RC, 9 floors above		
Car Parking	-		
Bicycle Parking	for 1 space ( Included )		
Music Instrument	-	Pet	
Facilities	Within 20 min to Roppongi by train / Within 20 min to Tokyo station by car / Janitor / Delivery box / Elevator / Security / Close to Station / 24h Garbage Drop-off / Newly-built (~7 y/o)		

\*The actual Layout & Size may differ slightly from this floor plans & pictures.



HOUSEREP TOKYO INC.

ハウスレップトーキョー株式会社

#301, 1-4-15, Hiroo, Shibuya-ku, Tokyo 150-0012, Japan

+81 (0)3 6427 5860

inquiry@housserrep-tokyo.com

Transaction Type : Intermediate

Agent Fee : 1 month + tax

Website : www.housserrep-tokyo.com



Remarks
Renters Insurance : Required / Pet:additional deposit ( 1 month ) / Pet : No Cats