

| | | | | | |
|---------------|-------------------------------|----------|------|--------|---|
| Property Name | LIETO COURT ARX TOWER | Unit No. | TYPE | Access | Shinntomichou Station on Hibiya Line (6 min) Hacchoubori Station on Hibiya Line (8 min) Tsukiji Station on Yurakucho Line (9 min) |
| | | 2503 | Apt. | | |
| Address | 3-8-1, Minato, Chuo-Ku, Tokyo | | | | |

Stylish High-rise Apartment in Tsukiji, Tokyo Bay Area

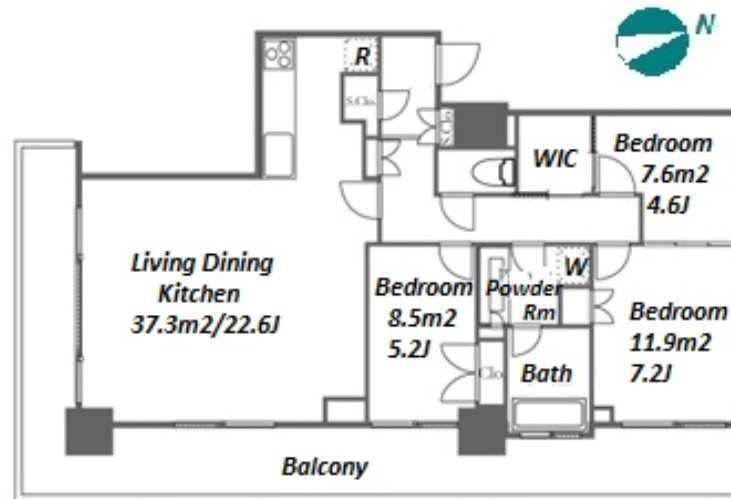

| Lease Conditions | | |
|------------------|---|-------------|
| LAYOUT | 3 BR | |
| SIZE | 91.76 m²/987.69 ft² | |
| RENT | JPY 538,000 / month | |
| Management Fee | JPY20,000/month | |
| Deposit | 2 months | Key Money - |
| Lease Term | Fixed term lease for 24 months | |
| Available | Now | |
| Renewal Fee | - | |
| Agent Fee | 1 month + tax | |
| Other Info | Key Replacement Fee : JPY18,000 Tax not included / No Key Money / Auto lock / Air-Con / Separated Toilet / Balcony / Penalty Fee for Early Cancellation / Musical Instrument Negotiable / Nice Views / Flooring / Floor Heating / Dishwasher / Bathroom dryer / WIC / Corner Unit | |

| Building Information | | | |
|----------------------|---|-----------------------|---------|
| Completion | Feb, 2007 | Earthquake Resistance | New |
| Structure | RC, 27 floors above and 1 basement floors | | |
| Car Parking | JPY37,000 + tax / month | | |
| Bicycle Parking | TBC | | |
| Music Instrument | Negotiable | Pet | Allowed |
| Facilities | Within 20 min to Tokyo station by car / Near Large Parks / Front desk / Concierge / Delivery box / Elevator / Sky lounge / Security / High-rise | | |

*The actual Layout & Size may differ slightly from this floor plans & pictures.



HOUSEREP TOKYO INC.

ハウスレップトーキョー株式会社

#301, 1-4-15, Hiroo, Shibuya-ku, Tokyo 150-0012, Japan

+81 (0)3 6427 5860

inquiry@housserep-tokyo.com

Transaction Type : Intermediate

Agent Fee : 1 month + tax

Website : www.housserep-tokyo.com



| Remarks |
|---|
| *Kid's Room *Guest Room(JPY.9,000) *Coworking Space(JPY.300+tax/h)*View lounge(JPY.2,000+tax/h) / Parking : 2 months for deposit / Pet:additional deposit (1 month) |