

Property Name	LIETO COURT ARX TOWER	Unit No.	TYPE	Access	Shinntomichou Station on Hibiya Line (6 min) Hacchoubori Station on Hibiya Line (8 min) Tsukiji Station on Yurakucho Line (9 min)
		1101	Apt.		
Address	3-8-1, Minato, Chuo-Ku, Tokyo				

Stylish High-rise Apartment in Tsukiji, Tokyo Bay Area

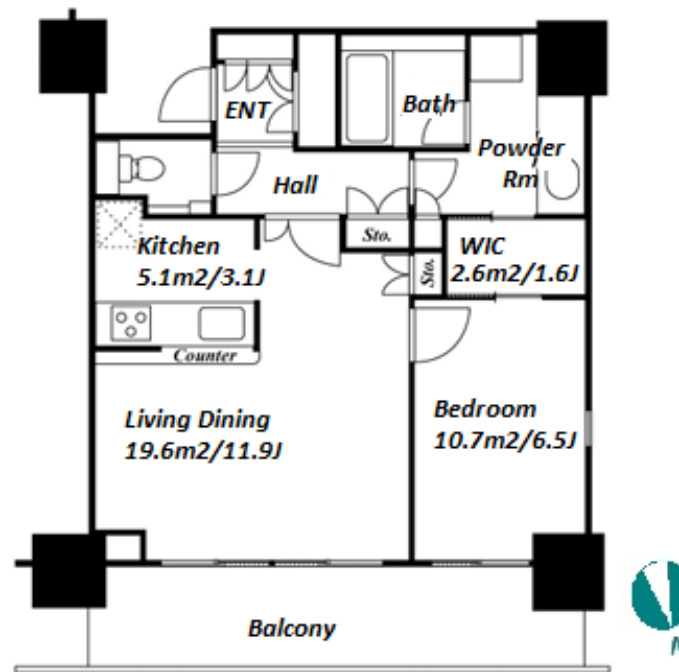

Lease Conditions			
LAYOUT	1 BR		
SIZE	56.91 m ² /612.57 ft ²		
RENT	JPY 263,000 / month		
Management Fee	JPY15,000/month		
Deposit	2 months	Key Money	-
Lease Term	Fixed term lease for 24 months		
Available	Now		
Renewal Fee	-		
Agent Fee	1 month + tax		
Other Info	Key Replacement Fee : JPY18,000 Tax not included / No Key Money / Auto lock / Air-Con / Separated Toilet / Balcony / Internet (Extra Charge) / Penalty Fee for Early Cancellation / Musical Instrument Negotiable / Flooring / Bathroom dryer / WIC		
Building Information			
Completion	Feb, 2007	Earthquake Resistance	New
Structure	RC, 27 floors above and 1 basement floors		
Car Parking	JPY37,000 + tax / month		
Bicycle Parking	TBC		
Musical Instrument	Negotiable	Pet	N/A
Facilities	Within 20 min to Tokyo station by car / Near Large Parks / Front desk / Concierge / Delivery box / Elevator / Sky lounge / Security / High-rise		

*The actual Layout & Size may differ slightly from this floor plans & pictures.



HOUSEREP TOKYO INC.

ハウスレップトーキョー株式会社

#301, 1-4-15, Hiroo, Shibuya-ku, Tokyo 150-0012, Japan

+81 (0)3 6427 5860

inquiry@housserrep-tokyo.com

Transaction Type : Intermediate

Agent Fee : 1 month + tax

Website : www.housserrep-tokyo.com



Remarks	
*Kid's Room *Guest Room(JPY.9,000) *Coworking Space(JPY.300+tax/h)*View lounge(JPY.2,000+tax/h) / Parking : 2 months for deposit	