

Property Name	PARK CUBE NISHIGAHARA STAGE	Unit No.	TYPE	Access	Nishisugamo Station on Mita Line (9 min) Nishigahara Station on Namboku Line (11 min) Sugamo Station on JR Yamanote Line (16 min)
		546	Apt.		
Address	4-51-35, Nishigahara, Kita-Ku, Tokyo				

Residential Mid-rise Apt. in Nishigahara

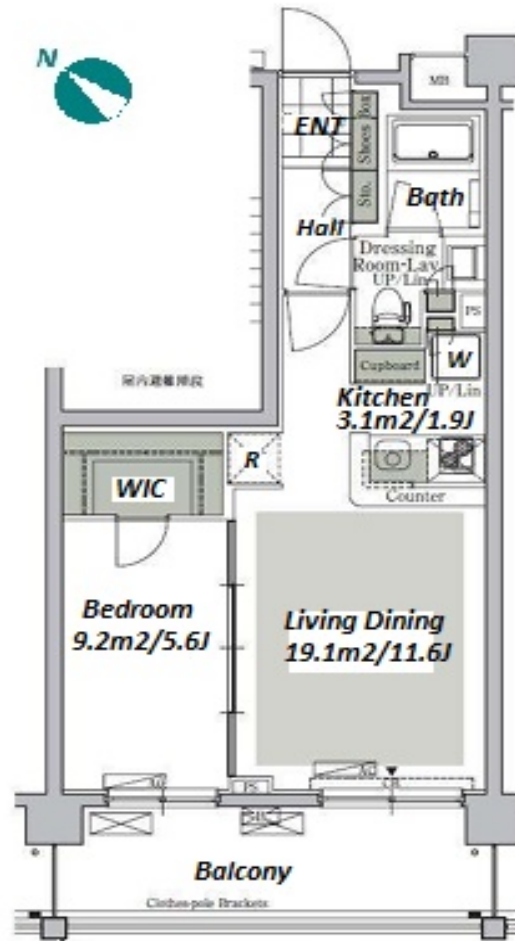
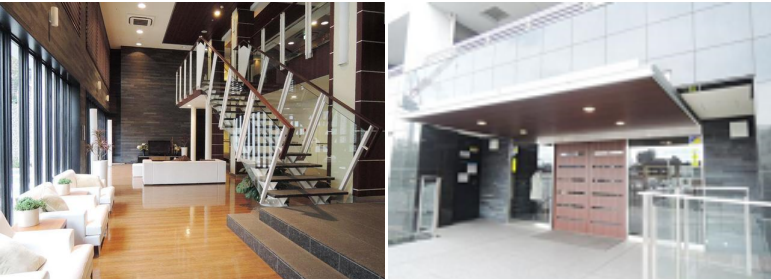

*The actual Layout & Size may differ slightly from this floor plans & pictures.

Lease Conditions	
LAYOUT	1 BR
SIZE	44.29 m²/476.73 ft²
RENT	JPY 161,000 / month
Management Fee	JPY10,000/month
Deposit	2 months
Key Money	-
Lease Term	Fixed term lease for 24 months
Available	Now
Renewal Fee	-
Agent Fee	1 month + tax
Other Info	Key Replacement Fee : JPY15,000 Tax not included / Guarantor Company : TBC / No Key Money / Auto lock / Air-Con / Separated Toilet / Balcony / Internet Included / Penalty Fee for Early Cancellation / Musical Instrument Negotiable / CS/CATV / Flooring / Floor Heating / Bathroom dryer / WIC

Building Information	
Completion	Dec, 2009
Earthquake Resistance	New
Structure	RC, 14 floors above and 2 basement floors
Car Parking	extra charge
Bicycle Parking	for 2 spaces (Included)
Music Instrument	Negotiable
Pet	Allowed
Facilities	Motorcycle Parking (TBC) / Near Large Parks / Concierge / Delivery box / Elevator

Remarks	
Renters Insurance : Required / Town association fee: JPY.3,000/2years / Bicycle parking : Registration fee: JPY.2,000+tax / Pet:additional deposit (1 month) / Pet : a small dog or up to two cats	



HOUSEREP TOKYO INC.

ハウズレップトーキョー株式会社

#301, 1-4-15, Hiroo, Shibuya-ku, Tokyo 150-0012, Japan

+81 (0)3 6427 5860

inquiry@housserep-tokyo.com

Transaction Type : Intermediate

Agent Fee : 1 month + tax

Website : www.housserep-tokyo.com

