

Property Name	PARK AXIS KINSHIKOEN	Unit No.	TYPE	Access	Kinshichou Station on Hanzomon Line (5 min) Kinshichou Station on JR Chuo-Sobu Line (6 min)
		1201	Apt.		
Address	4-10-4, Kinshi, Sumida-Ku, Tokyo				

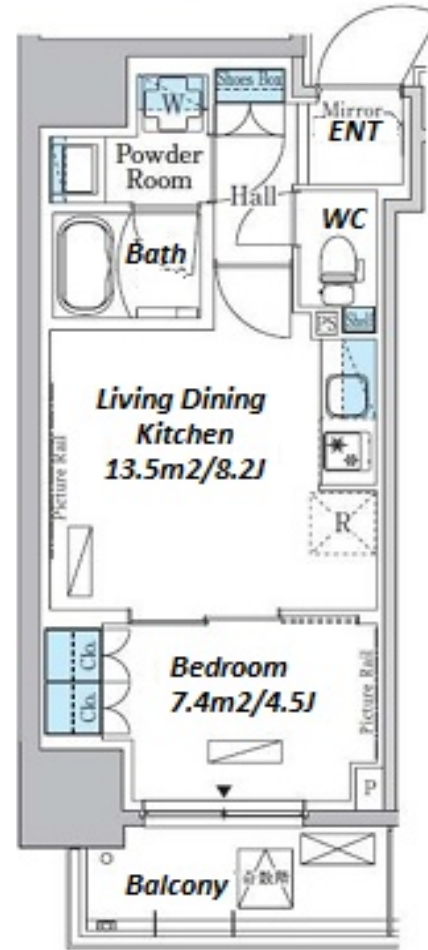

## Lease Conditions

LAYOUT	1 BR		
SIZE	34.21 m²/368.23 ft²		
RENT	JPY 164,000 / month		
Management Fee	JPY18,000/month		
Deposit	2 months	Key Money	1 month
Lease Term	Standard lease for 24 months		
Available	End, Jul, 2024		
Renewal Fee	1 month		
Agent Fee	1 month + tax		
Other Info	Key Replacement Fee : JPY15,000 Tax not included / Guarantor Company : TBC / Auto lock / Air-Con / Separated Toilet / Balcony / Internet Included / Penalty Fee for Early Cancellation / Musical Instrument Negotiable / CS/CATV / Flooring / Bathroom dryer		

## Building Information

Completion	Apr, 2023	Earthquake Resistance	New
Structure	RC, 14 floors above		
Car Parking	JPY30,000 + tax / month		
Bicycle Parking	for 1 space JPY300 + tax / month		
Music Instrument	Negotiable	Pet	Allowed
Facilities	Motorcycle Parking (extra charge) / Delivery box / Elevator / Close to Station / Newly-built (~7 y/o)		

## Remarks

Renters Insurance : Required / Bicycle parking : registration fee :  
JPY1,000+tax / Pet:additional deposit ( 1 month ) / Pet : a small dog or a  
cat

\*The actual Layout & Size may differ slightly from this floor plans & pictures.



HOUSEREP TOKYO INC.

ハウスレップトーキョー株式会社

#301, 1-4-15, Hiroo, Shibuya-ku, Tokyo 150-0012, Japan

+81 (0)3 6427 5860

inquiry@housserrep-tokyo.com

Transaction Type : Intermediate

Agent Fee : 1 month + tax

Website : www.housserrep-tokyo.com

