

Property Name	HIRAKAWACHO MORI TOWER RESIDENCE	Unit No.	TYPE	Access	Nagatacho Station on Hanzomon Line (1 min) Nagatacho Station on Namboku Line (1 min) Akasakamitsuke Station on Ginza Line (6 min)
		1708	Apt.		
Address	2-16-2, Hirakawacho, Chiyoda-Ku, Tokyo				

## High Rise Apartment at the hub of Business & Politics in Japan

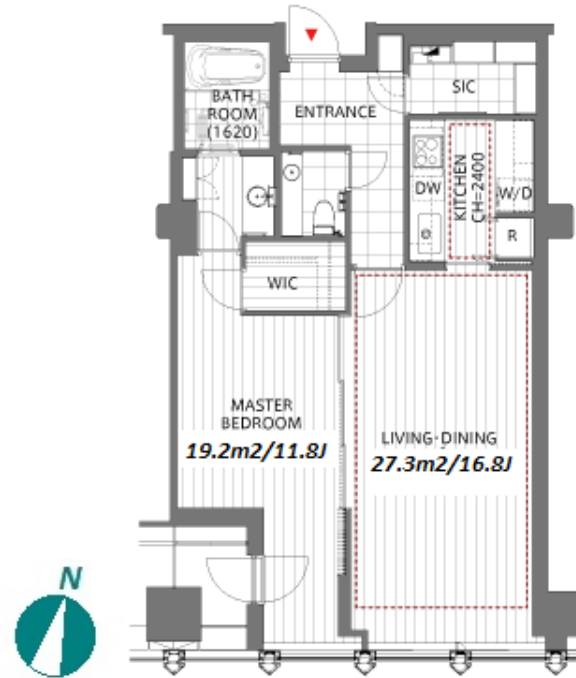
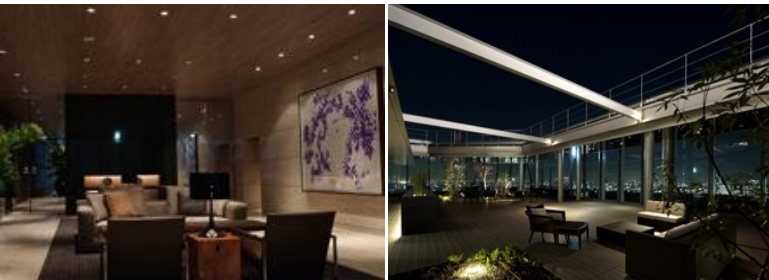

Lease Conditions		
LAYOUT	1 BR	
SIZE	77.84 m <sup>2</sup> /837.86 ft <sup>2</sup>	
RENT	JPY 600,000 / month	
Management Fee	-	
Deposit	4 months	Key Money -
Lease Term	Fixed term lease for 36 months	
Available	Mid, Oct, 2024	
Renewal Fee	-	
Agent Fee	1 month + tax	
Other Info	No Key Money / Auto lock / Fridge / Air-Con / Separated Toilet / Balcony / Penalty Fee for Early Cancellation / BBQ place / Roof Balcony / Washer / Dryer / Oven	

Building Information		
Completion	Dec, 2008	Earthquake Resistance New
Structure	RC, SRC, 24 floors above and 2 basement floors	
Car Parking	TBC	
Bicycle Parking	N/A	
Music Instrument	-	Pet Negotiable
Facilities	Motorcycle Parking (TBC) / Gym (TBC) / Within 20 min to Roppongi by train / Within 20 min to Tokyo station by car / Near Large Parks / pool / Front desk / Elevator / Sky lounge / Close to Station / High-rise	

Remarks
Renters Insurance : Required

\*The actual Layout & Size may differ slightly from this floor plans & pictures.



**HOUSEREP TOKYO INC.**

ハウスレップトーキョー株式会社

#301, 1-4-15, Hiroo, Shibuya-ku, Tokyo 150-0012, Japan

+81 (0)3 6427 5860 inquiry@housserep-tokyo.com

Transaction Type : Intermediate

Agent Fee : 1 month + tax

Website : www.housserep-tokyo.com

