

Property Name	AREA TOGOSHIKOEN	Unit No.	TYPE	Access	Togoshi Station on Toei Asakusa Line (5 min) Togoshikouenn Station on Oimachi Line (5 min)
		501	Apt.		
Address	5-14-22, Togoshi, Shinagawa-Ku, Tokyo				

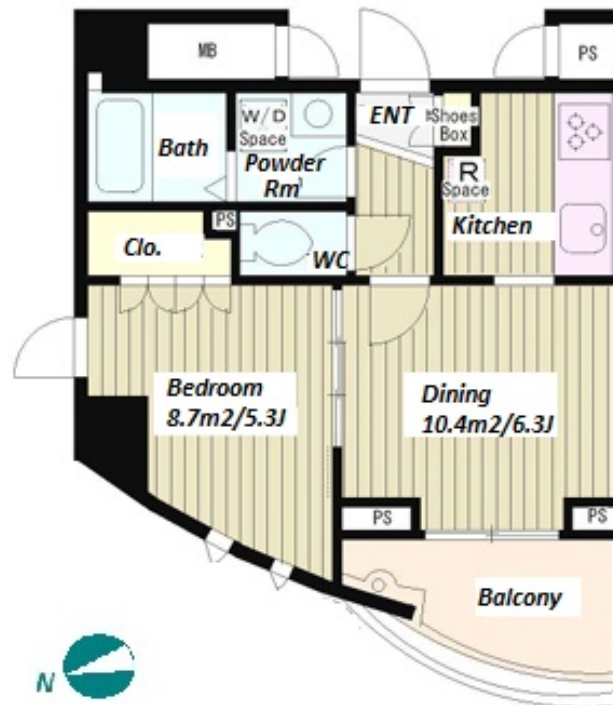

Lease Conditions

LAYOUT	1 BR		
SIZE	34.51 m²/371.46 ft²		
RENT	JPY 133,000 / month		
Management Fee	JPY10,000/month		
Deposit	2 months	Key Money	2 months
Lease Term	Standard lease for 24 months		
Available	End, May, 2024		
Renewal Fee	1 month		
Agent Fee	1 month + tax		
Other Info	Key Replacement Fee : JPY20,000 Tax not included / Auto lock / Air-Con / Separated Toilet / Balcony / CS/CATV / Flooring / Bathroom dryer		

Building Information

Completion	Oct, 2011	Earthquake Resistance	New
Structure	RC, 14 floors above		
Car Parking	N/A		
Bicycle Parking	for 1 space (Included)		
Music Instrument	-	Pet	-
Facilities	Motorcycle Parking (TBC) / Janitor / Delivery box / Elevator		

Remarks

Renters Insurance : Required

*The actual Layout & Size may differ slightly from this floor plans & pictures.



HOUSEREP TOKYO INC.

ハウスレップトーキョー株式会社

#301, 1-4-15, Hiroo, Shibuya-ku, Tokyo 150-0012, Japan

+81 (0)3 6427 5860

inquiry@housserrep-tokyo.com

Transaction Type : Intermediate

Agent Fee : 1 month + tax

Website : www.housserrep-tokyo.com

