

| | | | | | |
|---------------|---|----------|------|--------|---|
| Property Name | PARK AXIS NIHONBASHI KAYABACHO STATION GATE | Unit No. | TYPE | Access | Kayabachou Station on Hibiya Line (3 min) Kayabachou Station on Tozai Line (3 min) |
| | | 501 | Apt. | | |
| Address | 2-5-9, Nihombashikayabacho, Chuo-Ku, Tokyo | | | | |

Modern Mid Rise Apt. near Kayabacho stn.

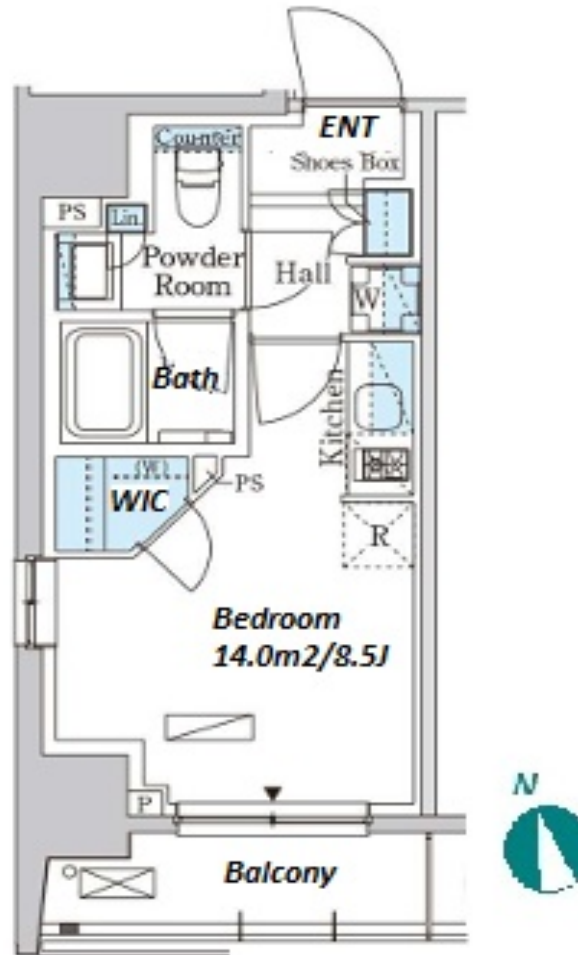

*The actual Layout & Size may differ slightly from this floor plans & pictures.

| Lease Conditions | |
|------------------|--|
| LAYOUT | Studio |
| SIZE | 25.91 m²/278.89 ft² |
| RENT | JPY 165,000 / month |
| Management Fee | JPY10,000/month |
| Deposit | 2 months |
| Key Money | - |
| Lease Term | Standard lease for 24 months |
| Available | Now |
| Renewal Fee | 1 month |
| Agent Fee | 1 month + tax |
| Other Info | Guarantor Company : TBC / No Key Money / Free rent / Auto lock / Air-Con / Separated Toilet / Balcony / Penalty Fee for Early Cancellation / Musical Instrument Negotiable / CS/CATV / Flooring / Bathroom dryer / WIC |

| Building Information | | | |
|----------------------|--|-----------------------|---------|
| Completion | Sep, 2023 | Earthquake Resistance | New |
| Structure | RC, 12 floors above | | |
| Car Parking | - | | |
| Bicycle Parking | JPY300 + tax / month | | |
| Music Instrument | Negotiable | Pet | Allowed |
| Facilities | Within 20 min to Tokyo station by car / Janitor / Delivery box / Elevator / Close to Station / 24h Garbage Drop-off / Newly-built (~1 y/o) | | |

| Remarks |
|---|
| Renters Insurance : Required / Key replacement: extra charge / Pet:additional deposit (1 month) |



HOUSEREP TOKYO INC.

ハウスレップトーキョー株式会社

#301, 1-4-15, Hiroo, Shibuya-ku, Tokyo 150-0012, Japan

+81 (0)3 6427 5860

inquiry@housserep-tokyo.com

Transaction Type : Intermediate

Agent Fee : 1 month + tax

Website : www.housserep-tokyo.com

