

Property Name	KDX Residence Nihonbashisuitengu	Unit No.	TYPE	Access	Suitennguumae Station on Hanzomon Line (2 min) Ninngyouchou Station on Hibiya Line (7 min)
		406	Apt.		
Address	41-6, Nihombashihakozakicho, Chuo-Ku, Tokyo				

Modern Mid Rise Apt. in Nihonbashi, near Suitengu stn.

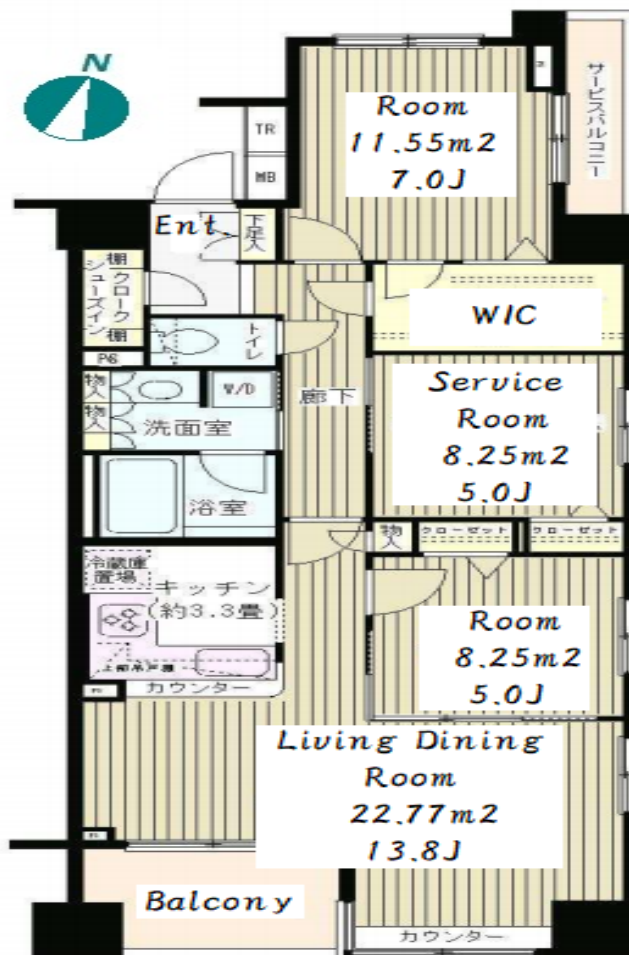

*The actual Layout & Size may differ slightly from this floor plans & pictures.

Lease Conditions			
LAYOUT	2 BR		
SIZE	80.04 m ² /861.54 ft ²		
RENT	JPY 277,000 / month		
Management Fee	JPY20,000/month		
Deposit	1 month	Key Money	1 month
Lease Term	Standard lease for 24 months		
Available	Early, May, 2024		
Renewal Fee	1 month		
Agent Fee	1 month + tax		
Other Info	Key Replacement Fee : JPY20,000 Tax not included / Auto lock / Air-Con / Separated Toilet / Balcony / Penalty Fee for Early Cancellation / Musical Instrument Negotiable / Flooring / Bathroom dryer / WIC		

Building Information			
Completion	Mar, 2005	Earthquake Resistance	New
Structure	RC, 11 story		
Car Parking	TBC		
Bicycle Parking	for 1 space (Included)		
Music Instrument	Negotiable	Pet	-
Facilities	Within 20 min to Roppongi by train / Near Large Parks / Janitor / Delivery box / Elevator		

Remarks
Renters Insurance : Required



HOUSEREP TOKYO INC.

ハウズレップトーキョー株式会社

#301, 1-4-15, Hiroo, Shibuya-ku, Tokyo 150-0012, Japan

+81 (0)3 6427 5860

inquiry@housserep-tokyo.com

Transaction Type : Intermediate

Agent Fee : 1 month + tax

Website : www.housserep-tokyo.com

