

Property Name	SERESA NIHONBASHI HORIDOMECHO	Unit No.	TYPE	Access	Ninngyouchou Station on Hibiya Line (2 min) Shinnnihonnbashi Station on JR Sobu Line (10 min)
		603	Apt.		
Address	1-8-13, Nihombashihoridomecho, Chuo-Ku, Tokyo				

## Middle Rise Apt. in Horidomecho, Ningyocho Area

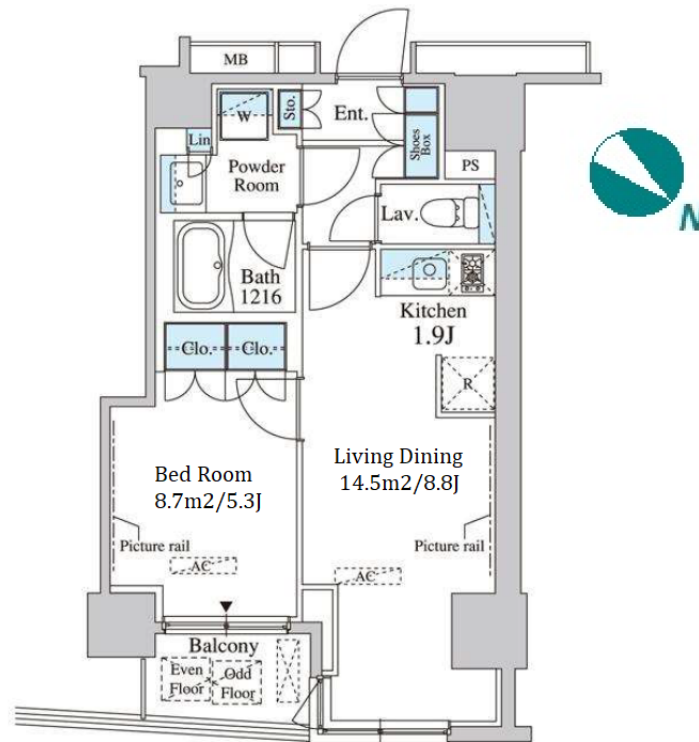

Lease Conditions			
LAYOUT	1 BR		
SIZE	40.04 m <sup>2</sup> /430.98 ft <sup>2</sup>		
RENT	JPY 163,000 / month		
Management Fee	JPY15,000/month		
Deposit	2 months	Key Money	1 month
Lease Term	Standard lease for 24 months		
Available	Early, Jun, 2024		
Renewal Fee	1 month		
Agent Fee	1 month + tax		
Other Info	Key Replacement Fee : JPY20,000 Tax not included / Guarantor Company : TBC / Auto lock / Air-Con / Separated Toilet / Balcony / Internet (Extra Charge) / Penalty Fee for Early Cancellation / CS/CATV / Flooring / Bathroom dryer		

Building Information			
Completion	Nov, 2012	Earthquake Resistance	New
Structure	RC, 14 story		
Car Parking	JPY38,500 + tax / month		
Bicycle Parking	for 1 space ( Included )		
Music Instrument	-	Pet	-
Facilities	Motorcycle Parking (TBC) / Within 20 min to Tokyo station by car / Near Large Parks / Janitor / Delivery box / Elevator / Security / Close to Station		

Remarks
Renters Insurance : Required

\*The actual Layout & Size may differ slightly from this floor plans & pictures.



# HOUSEREP TOKYO INC.

ハウズレップトーキョー株式会社

#301, 1-4-15, Hiroo, Shibuya-ku, Tokyo 150-0012, Japan

+81 (0)3 6427 5860

inquiry@housserep-tokyo.com

Transaction Type : Intermediate

Agent Fee : 1 month + tax

Website : www.housserep-tokyo.com

