

Property Name	RUBIA AKASAKA	Unit No.	TYPE	Access	Akasakamitsuke Station on <b>Ginza</b> Line (7 min) Nagatachou Station on <b>Namboku</b> Line (12 min)
		405	Apt.		
Address	4-9-11, Akasaka, Minato-Ku, Tokyo				

## Modern Mid-rise Apt. in Akasaka

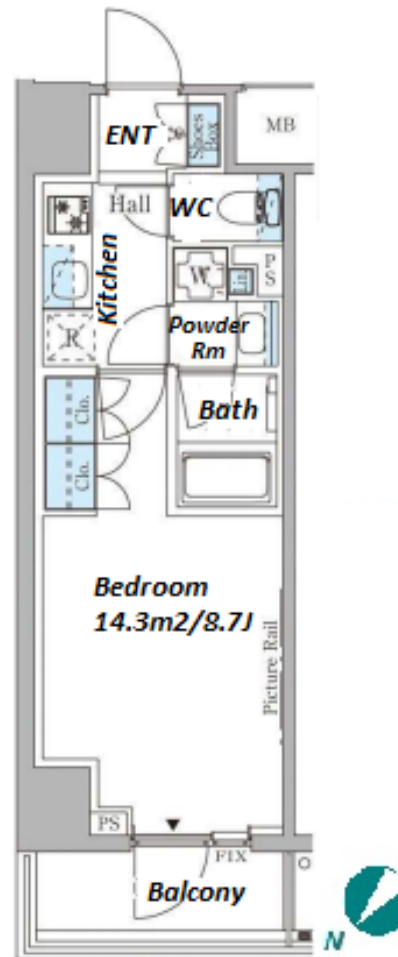

\*The actual Layout & Size may differ slightly from this floor plans & pictures.

Lease Conditions			
LAYOUT	Studio		
SIZE	27.99 m²/301.28 ft²		
RENT	JPY 140,000 / month		
Management Fee	JPY10,000/month		
Deposit	2 months	Key Money	1 month
Lease Term	Standard lease for 24 months		
Available	End, Jul, 2024		
Renewal Fee	1 month		
Agent Fee	1 month + tax		
Other Info	Key Replacement Fee : JPY20,000 Tax not included / Guarantor Company : TBC / Auto lock / Air-Con / Separated Toilet / Balcony / Penalty Fee for Early Cancellation / Flooring / Bathroom dryer		

Building Information			
Completion	Aug, 2019	Earthquake Resistance	New
Structure	RC, 12 story		
Car Parking	N/A		
Bicycle Parking	for 1 space ( Included )		
Music Instrument	-	Pet	-
Facilities	Motorcycle Parking (TBC) / Delivery box / Elevator		

Remarks
Renters Insurance : Required



**HOUSEREP TOKYO INC.**

ハウスレップトーキョー株式会社

#301, 1-4-15, Hiroo, Shibuya-ku, Tokyo 150-0012, Japan

+81 (0)3 6427 5860 inquiry@housserep-tokyo.com

Transaction Type : Intermediate

Agent Fee : 1 month + tax

Website : www.housserep-tokyo.com

