

Sales Price	131,000,000 JPY	Access	Toritsudaigaku Station on	Toyoko Line 7 min. walk
Tax	Included		Midorigaoka Station on	Oimachi Line 16 min. walk
			Ookayama Station on	Tokyu Meguro Line 16 min. walk

Property Name	TAIRAMACHI 2CHOME HOUSE B
----------------------	---------------------------

Brand New Twin House in Calm Residential Area, 3 Stations 3 Lines Available

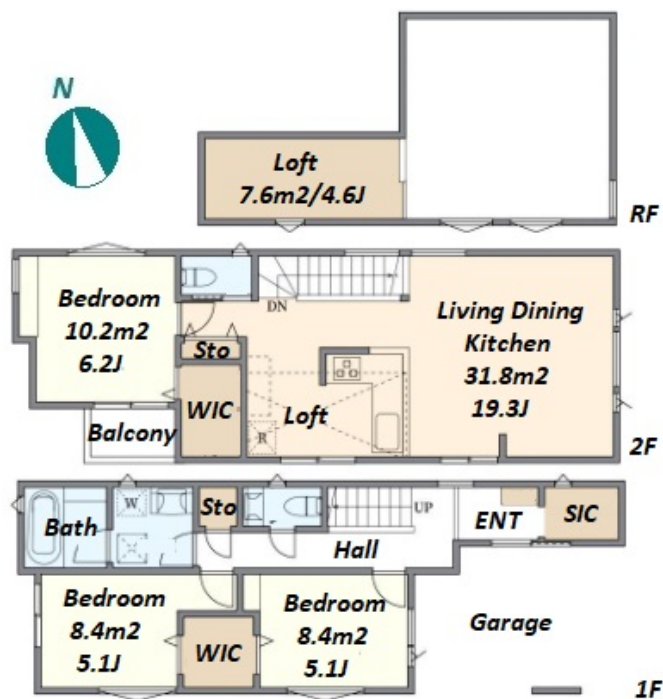

*The actual Layout & Size may differ slightly from this floor plans & pictures.

Address	2, Tairamachi, Meguro-Ku, Tokyo
----------------	---------------------------------

Unit/Property Information			
LAYOUT	3 BR	Management Fee	-
Unit Floor	1F~2F	Repair Fund	-
Floor Size(sqm)	104 m ²	Other Fee	-
Floor Size(sqft)	1119.44 ft ²	Total Monthly Fee	-
Balcony	-	Current Status	Under construction
Facing	South	Hand Over	End, Apr, 2024
Unit Facilities	Pet friendly, Separated Toilet, Balcony, Loft/Maisonnette, Floor Heating, Dishwasher, WIC, 2 Toilets		

Building Information			
Structure	Wooden 2 floors above		
Total Units	-	Completion	Mar, 2024
Car Parking	(Included)	Pet	Negotiable
Developer Name	-		
Management company&Type	-		
Common Facility	Motorcycle Parking ((Included)), House, New Earthquake Resistance Standard, Newly-built (~1 y/o)		

Remarks
<Unit/Property Information>
<Building Information>
<Land Information> [Road Adjacent] (1) Southeast/Private/3.5m

Land Information			
Lot Area	77.13 m ²	Land lease term	-
Ownership Type	Ownership	Land lease fee	-
Co-owner's Share	-	Land Category	Residential
City Planning area	Urban Planning District / Quasi-fire Prevention Area		
Use Zoning	Category I exclusively low-rise residential zone		
Current Status	-	Bldg. to Land %	60%
Hand Over	-	Floor to Land %	150%
Private Road	3.4m ² ;	Set Back	-
Other Conditions			



HOUSEREP TOKYO INC.

ハウスレップトーキョー株式会社

#301, 1-4-15, Hiroo, Shibuya-ku, Tokyo 150-0012, Japan

+81 (0)3 6427 5860

inquiry@housserep-tokyo.com

Transaction Type : Intermediate

Agent Fee : (3%+60,000JPY) + tax

Website : www.housserep-tokyo.com

