

FOR RENT		Property ID No. :152892			HOUSEREP TOKYO INC.		Website : www.housserep-tokyo.com		
Property Name	PARK AXIS OCHANOMIZU STAGE		Unit No.	TYPE	Access	Suehirochou Station on Ginza Line (6 min)			
			1204	Apt.		Yushima Station on Chiyoda Line (6 min)			
Address	3-2-14, Yushima, Bunkyo-Ku, Tokyo					Ochanomizu Station on JR Chuo Line Rapid Service (8 min)			
						Akihabara Station on JR Yamanote Line (13 min)			

Lease Conditions			
LAYOUT	1 BR		
SIZE	44.57 m²/479.74 ft²		
RENT	JPY 209,000 / month		
Management Fee	JPY10,000/month		
Deposit	2 months	Key Money	1 month
Lease Term	Standard lease for 24 months		
Available	End, Apr, 2024		
Renewal Fee	1 month		
Agent Fee	1 month + tax		
Other Info	Key Replacement Fee : JPY15,000 Tax not included / Guarantor Company : TBC / Auto lock / Air-Con / Separated Toilet / Balcony / Penalty Fee for Early Cancellation / Musical Instrument Negotiable / CS/CATV / Floor Heating / Bathroom dryer		
Building Information			
Completion	Feb, 2006	Earthquake Resistance	New
Structure	RC, 14 story		
Car Parking	extra charge		
Bicycle Parking	for 1 space (Included)		
Music Instrument	Negotiable	Pet	Allowed
Facilities	Motorcycle Parking (TBC) / Within 20 min to Tokyo station by car / Janitor / Delivery box / Elevator / Security		
Remarks			

Mid-rise Apt. in Ochanomizu, near Akihabara

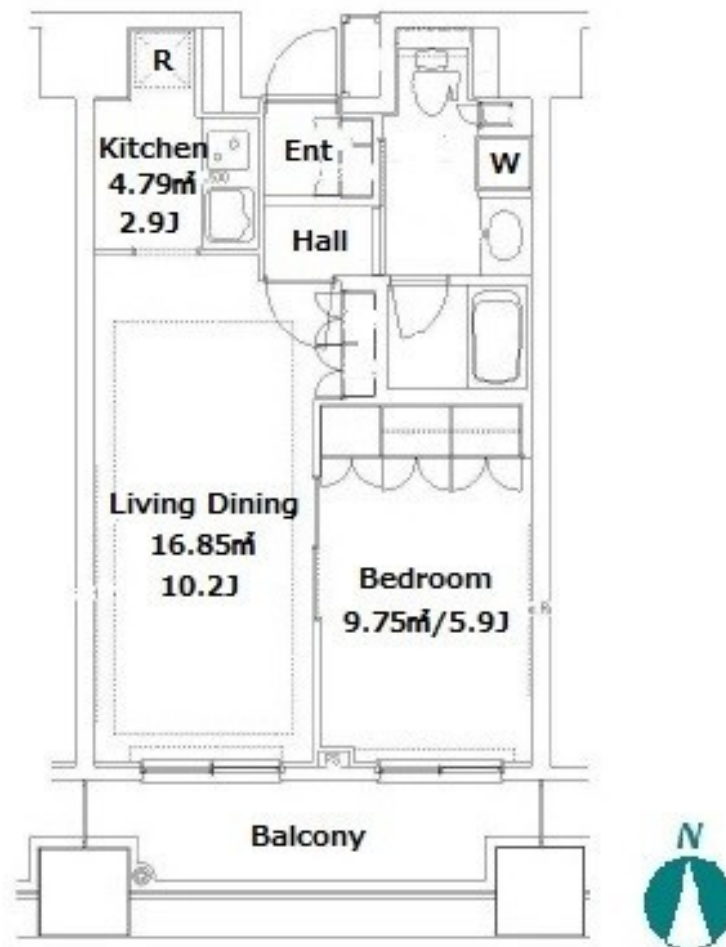
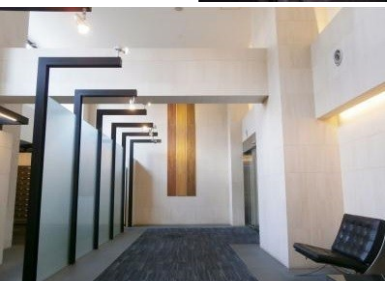

*The actual Layout & Size may differ slightly from this floor plans & pictures.

Renters Insurance : Required / Bicycle parking : Registration fee:
JPY.2,000+tax / Pet:additional deposit (1 month) / Pet : up to two small
dogs/ No cat



HOUSEREP TOKYO INC.
ハウスレップトーキョー 株式会社

#301, 1-4-15, Hiroo, Shibuya-ku, Tokyo 150-0012, Japan
+81 (0)3 6427 5860 inquiry@houserep-tokyo.com

Transaction Type : Intermediate
Agent Fee : 1 month + tax

Website : www.houserep-tokyo.com

