

FOR RENT

Property ID No. :152858

HOUSEREP TOKYO INC.

Website : www.housserep-tokyo.com

Property Name	PARK AXIS RYOGOKU SQUARE	Unit No.	TYPE	Access	Ryougoku Station on Oedo Line (2 min)
		406	Apt.		
Address	1-16-4, Midori, Sumida-Ku, Tokyo				

Mid-rise Apt. in Ryogoku, Sumida

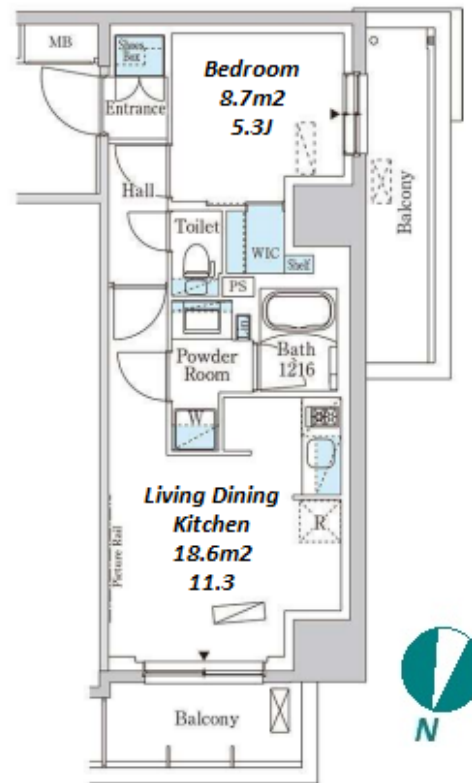

Lease Conditions			
LAYOUT	1 BR		
SIZE	40.48 m²/435.72 ft²		
RENT	JPY 183,000 / month		
Management Fee	JPY15,000/month		
Deposit	2 months	Key Money	1 month
Lease Term	Standard lease for 24 months		
Available	End, Apr, 2024		
Renewal Fee	1 month		
Agent Fee	1 month + tax		
Other Info	Key Replacement Fee : JPY20,000 Tax not included / Guarantor Company : TBC / Auto lock / Air-Con / Separated Toilet / Balcony / Musical Instrument Negotiable / Flooring / Bathroom dryer / WIC		

Building Information			
Completion	Dec, 2022	Earthquake Resistance	New
Structure	RC, 13 story		
Car Parking	N/A		
Bicycle Parking	for 1 space (Included)		
Music Instrument	Negotiable	Pet	Allowed
Facilities	Motorcycle Parking (TBC) / Delivery box / Elevator / Close to Station / Newly-built (~1 y/o)		

*The actual Layout & Size may differ slightly from this floor plans & pictures.



HOUSEREP TOKYO INC.

ハウスレップトーキョー株式会社

#301, 1-4-15, Hiroo, Shibuya-ku, Tokyo 150-0012, Japan

+81 (0)3 6427 5860 inquiry@housserep-tokyo.com

Transaction Type : Intermediate

Agent Fee : 1 month + tax

Website : www.housserep-tokyo.com



Remarks
Renters Insurance : Required / Bicycle parking : Registration fee: JPY.2,000+tax / Pet:additional deposit (1 month) / Pet : a small dog or a cat