

FOR RENT

Property ID No. :152800

HOUSEREP TOKYO INC.

Website : www.housserep-tokyo.com

Property Name	JP NOIE KINSHICHO	Unit No.	TYPE	Access	Kinnsichou Station on JR Chuo-Sobu Line (9 min) Kinnsichou Station on Hanzomon Line (9 min) Ryougoku Station on Oedo Line (11 min)
		305	Apt.		
Address	4-15-18, Kamezawa, Sumida-Ku, Tokyo				

Modern Apt. near lively Kinshicho district

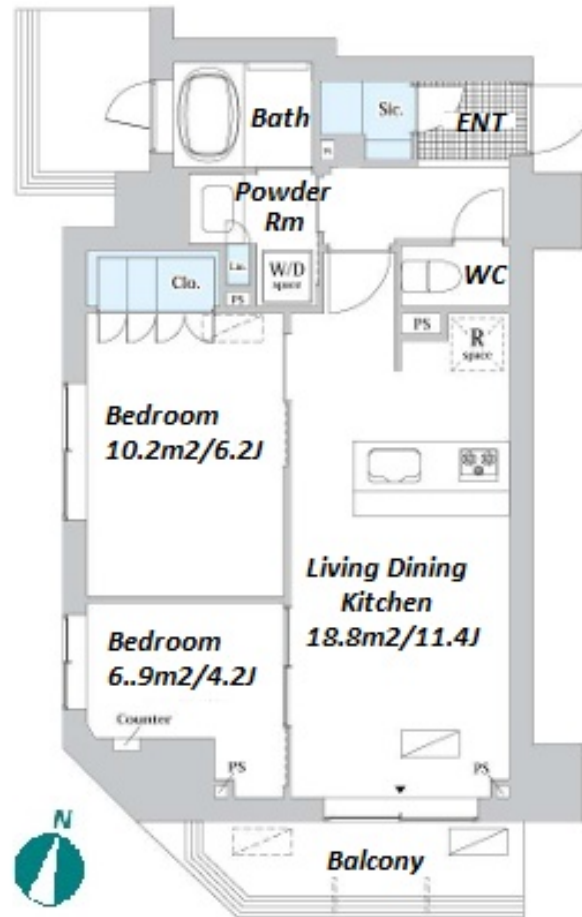

*The actual Layout & Size may differ slightly from this floor plans & pictures.

Lease Conditions			
LAYOUT	2 BR		
SIZE	50.51 m²/543.68 ft²		
RENT	JPY 221,000 / month		
Management Fee	JPY15,000/month		
Deposit	2 months	Key Money	1 month
Lease Term	Standard lease for 24 months		
Available	Early, Apr, 2024		
Renewal Fee	1 month		
Agent Fee	1 month + tax		
Other Info	Key Replacement Fee : JPY20,000 Tax not included / Guarantor Company : TBC / Auto lock / Air-Con / Separated Toilet / Balcony / CS/CATV / Flooring / IH Stoves / Bathroom dryer		

Building Information			
Completion	Aug, 2021	Earthquake Resistance	New
Structure	RC, 9 story		
Car Parking	N/A		
Bicycle Parking	for 1 space (Included)		
Music Instrument	-	Pet	N/A
Facilities	Motorcycle Parking (TBC) / Trunk Room (TBC) / Near Large Parks / Janitor / Delivery box / Elevator		

Remarks
Renters Insurance : Required



HOUSEREP TOKYO INC.

ハウスレップトーキョー株式会社

#301, 1-4-15, Hiroo, Shibuya-ku, Tokyo 150-0012, Japan

+81 (0)3 6427 5860 inquiry@housserep-tokyo.com

Transaction Type : Intermediate

Agent Fee : 1 month + tax

Website : www.housserep-tokyo.com

