

FOR RENT

Property ID No. :152753

HOUSEREP TOKYO INC.

Website : www.houserep-tokyo.com

Property Name	COMFORIA GINZA EAST	Unit No.	TYPE	Access	Hacchoubori Station on Hibiya Line (2 min) Shinntomichou Station on Yurakucho Line (5 min)
		305	Apt.		
Address	1-3-1, Irifune, Chuo-Ku, Tokyo				

Modern Mid Rize Apt. in Ginza, Near Hacchobori stn.

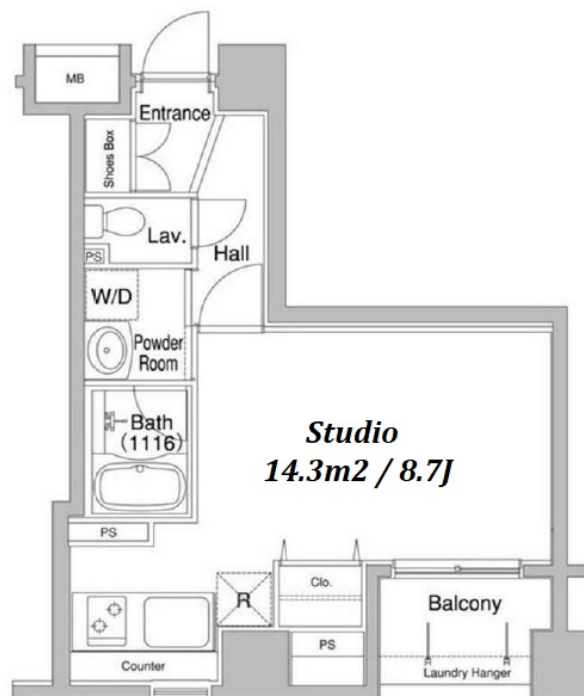

Lease Conditions		
LAYOUT	Studio	
SIZE	33.66 m²/362.31 ft²	
RENT	JPY 134,000 / month	
Management Fee	JPY10,000/month	
Deposit	1 month	Key Money -
Lease Term	Standard lease for 24 months	
Available	Mid, Mar, 2024	
Renewal Fee	1 month	
Agent Fee	1 month + tax	
Other Info	Key Replacement Fee : JPY20,000 Tax not included / No Key Money / Auto lock / Air-Con / Separated Toilet / Balcony / Internet (Extra Charge) / Penalty Fee for Early Cancellation / CS/CATV / Flooring / Bathroom dryer	

Building Information			
Completion	Mar, 2005	Earthquake Resistance	New
Structure	SRC, 14 story		
Car Parking	N/A		
Bicycle Parking	TBC		
Music Instrument	-	Pet	Allowed
Facilities	Within 20 min to Tokyo station by car / Near Large Parks / Janitor / Delivery box / Elevator / Security		

Remarks
Renters Insurance : Required / Pet:additional deposit (1 month)

*The actual Layout & Size may differ slightly from this floor plans & pictures.



HOUSEREP TOKYO INC.

ハウズレップトーキョー株式会社

#301, 1-4-15, Hiroo, Shibuya-ku, Tokyo 150-0012, Japan

+81 (0)3 6427 5860

inquiry@houserep-tokyo.com

Transaction Type : Intermediate

Agent Fee : 1 month + tax

Website : www.houserep-tokyo.com

