

Property Name	PARK AXIS MOTOAZABU	Unit No.	TYPE	Access	Azabujuban Station on Oedo Line (5 min) Azabujuban Station on Namboku Line (5 min)
		103	Apt.		
Address	1-2-12, Motoazabu, Minato-Ku, Tokyo				

Mid rise apartment in TOKYO near Azabujuban Sta.

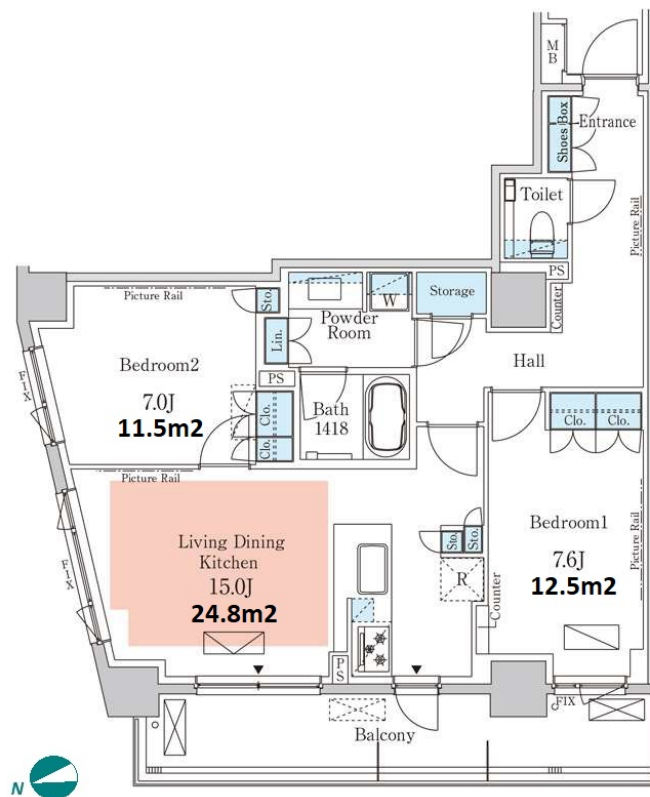

Lease Conditions

LAYOUT	2 BR		
SIZE	73.89 m²/795.34 ft²		
RENT	JPY 485,000 / month		
Management Fee	JPY15,000/month		
Deposit	2 months	Key Money	-
Lease Term	Fixed term lease for 24 months		
Available	Mid, Mar, 2024		
Renewal Fee	-		
Agent Fee	1 month + tax		
Other Info	Guarantor Company : TBC / No Key Money / Auto lock / Air-Con / Separated Toilet / Balcony / CS/CATV / Floor Heating / Dishwasher / Bathroom dryer		

Building Information

Completion	Feb, 2024	Earthquake Resistance	New
Structure	RC, 6 story		
Car Parking	N/A		
Bicycle Parking	for 1 space (Included)		
Music Instrument	-	Pet	
Facilities	Within 20 min to Roppongi by train / Janitor / Delivery box / Elevator / Security / Close to Station / Newly-built (~1 y/o)		

Remarks

Renters Insurance : Required / Bicycle parking : One-time sticker registration fee: 2,000yen+Tax / Pet:additional deposit (1 month)

*The actual Layout & Size may differ slightly from this floor plans & pictures.



HOUSEREP TOKYO INC.

ハウスレップトーキョー株式会社

#301, 1-4-15, Hiroo, Shibuya-ku, Tokyo 150-0012, Japan

+81 (0)3 6427 5860 inquiry@housserep-tokyo.com

Transaction Type : Intermediate

Agent Fee : 1 month + tax

Website : www.housserep-tokyo.com

