

Property Name	ADELE UKIMAFUNATO	Unit No.	TYPE	Access	Ukimafunado Station on JR Saikyo Line (10 min) Nishidai Station on Mita Line (24 min)
		601	Apt.		
Address	3-23-11, Funado, Itabashi-Ku, Tokyo				

Mid rise apartment in Itabashi area near Ukimafunato Sta.

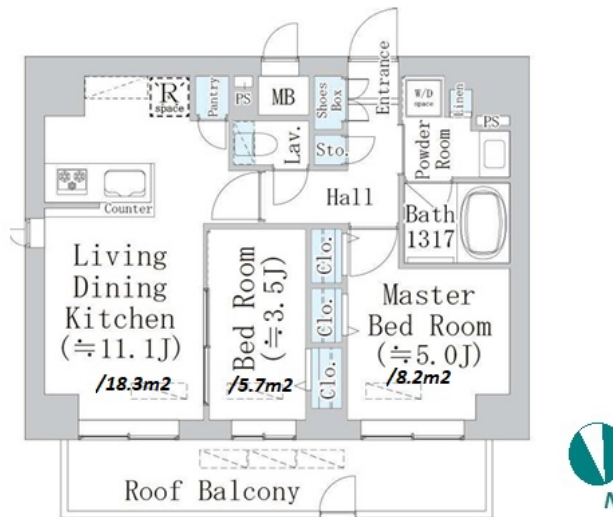

Lease Conditions			
LAYOUT	2 BR		
SIZE	47.4 m ² /510.2 ft ²		
RENT	JPY 160,000 / month		
Management Fee	-		
Deposit	1 month	Key Money	-
Lease Term	Standard lease for 24 months		
Available	End, Mar, 2024		
Renewal Fee	1 month		
Agent Fee	1 month + tax		
Other Info	No Key Money / Auto lock / Air-Con / Separated Toilet / Balcony / Internet Included / CS/CATV / Bathroom dryer		

Building Information			
Completion	Mar, 2024	Earthquake Resistance	New
Structure	RC, 7 story		
Car Parking	N/A		
Bicycle Parking	for 1 space (Included)		
Music Instrument	-	Pet	Negotiable
Facilities	Motorcycle Parking (extra charge) / Delivery box / Elevator / Security / 24h Garbage Drop-off / Newly-built (~1 y/o)		

*The actual Layout & Size may differ slightly from this floor plans & pictures.



HOUSEREP TOKYO INC.

ハウスレップトーキョー株式会社

#301, 1-4-15, Hiroo, Shibuya-ku, Tokyo 150-0012, Japan

+81 (0)3 6427 5860 inquiry@houserep-tokyo.com

Transaction Type : Intermediate

Agent Fee : 1 month + tax

Website : www.houserep-tokyo.com



Remarks
Renters Insurance : Required