

| | | | | | |
|---------------|---|----------|------|--------|---|
| Property Name | PARK AXIS YOKOHAMA BANNDoubashi | Unit No. | TYPE | Access | Banndoubashi Station on Blue Line (6 min) Koganechou Station on Keikyu Line (10 min) |
| | | 216 | Apt. | | |
| Address | 3-45, Urafunecho, Minami-Ku, Yokohama-Shi, Kanagawa | | | | |

Stylish Mid rise apartment in Yokohama area near Banndoubashi Sta.

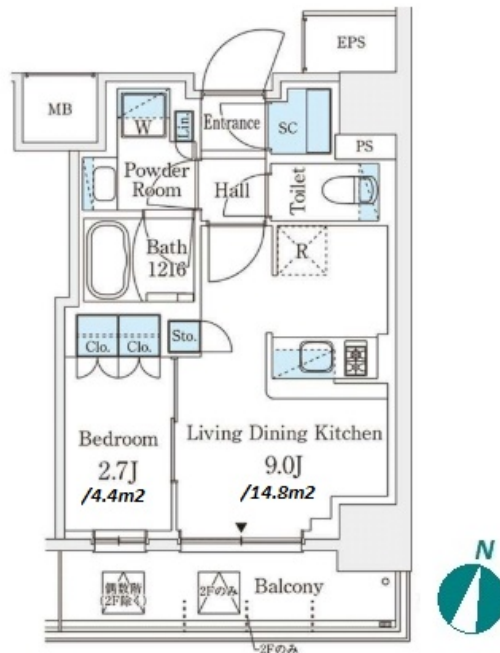

| Lease Conditions | | |
|------------------|---|-------------|
| LAYOUT | 1 BR | |
| SIZE | 32.05 m ² /344.98 ft ² | |
| RENT | JPY 109,000 / month | |
| Management Fee | JPY12,000/month | |
| Deposit | 1 month | Key Money - |
| Lease Term | Standard lease for 24 months | |
| Available | Now | |
| Renewal Fee | 1 month | |
| Agent Fee | 1 month + tax | |
| Other Info | Guarantor Company : TBC / No Key Money / Auto lock / Air-Con / Separated Toilet / Balcony / Musical Instrument Negotiable / Flooring / Bathroom dryer | |

| Building Information | | | |
|----------------------|---|-----------------------|-----|
| Completion | Oct, 2023 | Earthquake Resistance | New |
| Structure | RC, 10 story | | |
| Car Parking | JPY23,000 + tax / month | | |
| Bicycle Parking | extra charge | | |
| Music Instrument | Negotiable | Pet | |
| Facilities | Motorcycle Parking (TBC) / Delivery box / Elevator / 24h Garbage Drop-off | | |

| Remarks |
|---|
| Renters Insurance : Required / Pet:additional deposit (1 month) |

*The actual Layout & Size may differ slightly from this floor plans & pictures.



HOUSEREP TOKYO INC.

ハウスレップトーキョー株式会社

#301, 1-4-15, Hiroo, Shibuya-ku, Tokyo 150-0012, Japan

+81 (0)3 6427 5860

inquiry@housserrep-tokyo.com

Transaction Type : Intermediate

Agent Fee : 1 month + tax

Website : www.housserrep-tokyo.com

