

Property Name	SADOHARA TERRACE HOUSE	Unit No.	TYPE	Access	Ichigaya Station on JR Chuo Line Rapid Service (5 min) Ichigaya Station on JR Chuo Line Rapid Service (8 min) Ushigomekagurazaka Station on Oedo Line (10 min) Iidabashi Station on JR Chuo Line Rapid Service (11 min)
		102	House		
Address	3-17-9, Ichigayasadoharacho, Shinjuku-Ku, Tokyo				

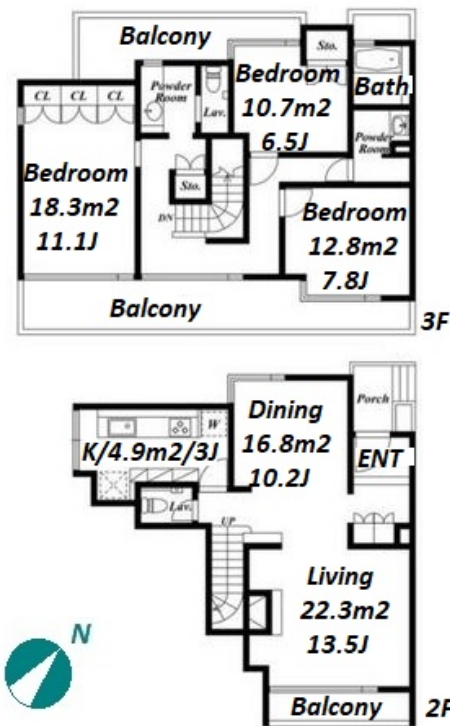
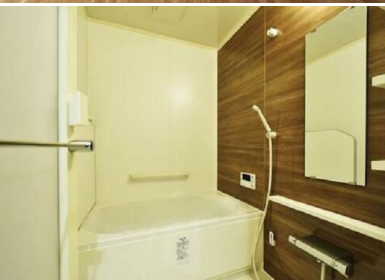

Lease Conditions

LAYOUT	3 BR		
SIZE	152 m²/1636.11 ft²		
RENT	JPY 600,000 / month		
Management Fee	-		
Deposit	2 months	Key Money	1 month
Lease Term	Fixed term lease for 24 months		
Available	Now		
Renewal Fee	-		
Agent Fee	1 month + tax		
Other Info	Air-Con / Separated Toilet / Balcony / Loft/Maisonnette / No Smoking / Flooring / 2 Toilets		

Building Information

Completion	Jan, 1987	Earthquake Resistance	New
Structure	RC, 2 story		
Car Parking	N/A		
Bicycle Parking	N/A		
Music Instrument	-	Pet	N/A
Facilities	Close to Station		

Remarks

Renters Insurance : Required

*The actual Layout & Size may differ slightly from this floor plans & pictures.



HOUSEREP TOKYO INC.

ハウスレップトーキョー株式会社

#301, 1-4-15, Hiroo, Shibuya-ku, Tokyo 150-0012, Japan

+81 (0)3 6427 5860

inquiry@housserrep-tokyo.com

Transaction Type : Intermediate

Agent Fee : 1 month + tax

Website : www.housserrep-tokyo.com

