

Sales Price	25,800,000 JPY	Access	Ropponngi Station on	Hibiya Line	7 min. walk
Tax	Included				

7min walk to Roppongi Station

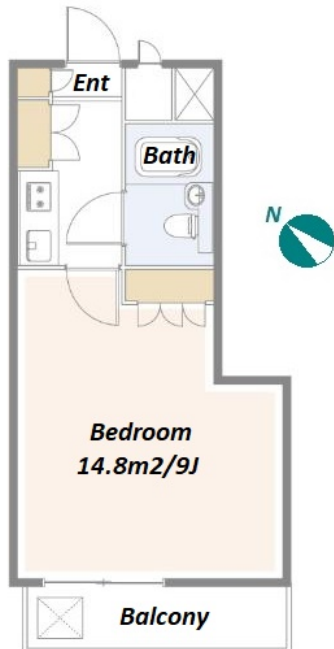

\*The actual Layout & Size may differ slightly from this floor plans & pictures.

Remarks
<p>&lt;Unit/Property Information&gt; [Remarks] Hot Water Supply (basic fee): JPY1,500/mo.</p> <p>&lt;Building Information&gt;</p> <p>&lt;Land Information&gt;</p>

[Apartment] FOR SALE		Gross Yield : 4.88%
Property Name	CROWN NISHIAZABU	

Address	3F, 3-19-13, Nishiazabu, Minato-Ku, Tokyo
---------	---

Unit/Property Information			
LAYOUT	1 BR	Management Fee	JPY11,080/month
Unit Floor	3F	Repair Fund	JPY8,864/month
Floor Size(sqm)	20.7 m²	Other Fee	JPY1,500/month
Floor Size(sqft)	222.81 ft²	Total Monthly Fee	JPY21,444/month
Balcony	2.85 m²	Current Status	Rented
Facing	Southwest	Hand Over	Negotiable
Unit Facilities	Pet : No, Renovated, Air-Con, Balcony, Bathroom dryer		

Building Information			
Structure	RC 5 floors above		
Total Units	56	Completion	Aug, 1976
Car Parking	( Not Included )	Pet	-
Developer Name	mitsueda shoten Co.,Ltd.		
Management company&Type	NIPPON KANZAI Co., Ltd. Partially Outsourced / Day Shift		
Common Facility	Within 20 min walk to Roppongi, Within 20 min to Roppongi by train, Within 20 min to Tokyo station by car, Elevator, Low-rise		

Land Information			
Lot Area	737.53 m²	Land lease term	-
Ownership Type	Ownership	Land lease fee	-
Co-ower's Share	-	Land Category	Residential
City Planning area	Urban Planning District		
Use Zoning	Category II mid/high-rise oriented residential zone		
Current Status	-	Bldg. to Land %	-
Hand Over	-	Floor to Land %	-
Private Road	-	Set Back	-
Other Conditions			