

FOR RENT

Property ID No. :151963

HOUSEREP TOKYO INC.

Website : www.housserep-tokyo.com

Property Name	Lefond Progres Asakusa Iriya	Unit No.	TYPE	Access	Iriya Station on Hibiya Line (8 min) Asakusa Station on (11 min)
		1304	Apt.		
Address	2-17-7, Senzoku, Taito-Ku, Tokyo				

Mid rise apartment in TOKYO near Iriya Sta.

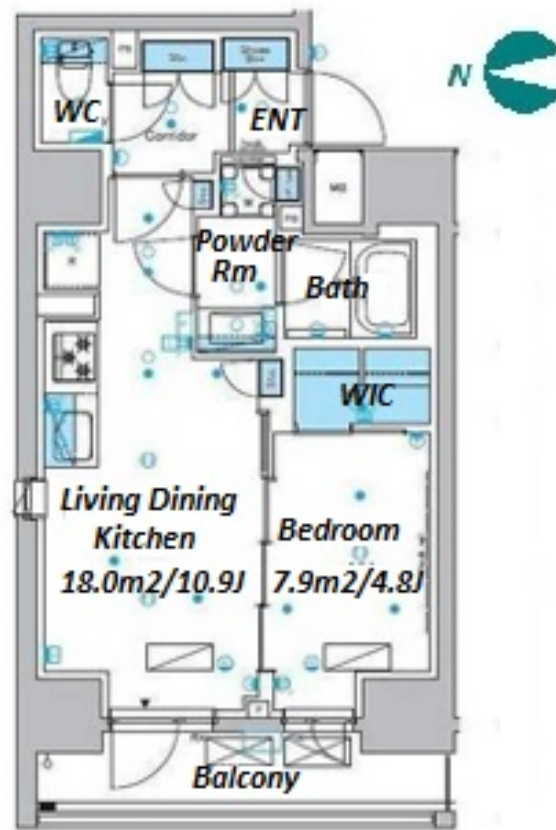

*The actual Layout & Size may differ slightly from this floor plans & pictures.

Lease Conditions			
LAYOUT	1 BR		
SIZE	40.59 m²/436.9 ft²		
RENT	JPY 160,000 / month		
Management Fee	JPY15,000/month		
Deposit	2 months	Key Money	-
Lease Term	Standard lease for 24 months		
Available	Now		
Renewal Fee	1 month		
Agent Fee	1 month + tax		
Other Info	Guarantor Company : TBC / No Key Money / Auto lock / Air-Con / Separated Toilet / Balcony / Internet Included / Penalty Fee for Early Cancellation / Flooring / Bathroom dryer / WIC		

Building Information			
Completion	Jan, 2022	Earthquake Resistance	New
Structure	RC, 14 story		
Car Parking	TBC		
Bicycle Parking	TBC		
Music Instrument	-	Pet	Allowed
Facilities	Motorcycle Parking (extra charge) / Janitor / Delivery box / Elevator / Security / Newly-built (~7 y/o)		

Remarks
Renters Insurance : Required / Pet:additional deposit (1 month) / Pet : a small dog or a cat



HOUSEREP TOKYO INC.

ハウスレップトーキョー株式会社

#301, 1-4-15, Hiroo, Shibuya-ku, Tokyo 150-0012, Japan

+81 (0)3 6427 5860 inquiry@housserep-tokyo.com

Transaction Type : Intermediate

Agent Fee : 1 month + tax

Website : www.housserep-tokyo.com

