

FOR RENT

Property ID No. :151958

HOUSEREP TOKYO INC.

Website : www.housserep-tokyo.com

| | | | | | |
|---------------|-------------------------------------|----------|------|--------|---|
| Property Name | COMFORIA FUTABA | Unit No. | TYPE | Access | Nishiooi Station on JR Yokosuka Line (8 min) Shimoshinnmei Station on Oimachi Line (8 min) Ooimachi Station on JR Keihin Tohoku Line (16 min) |
| | | 501 | Apt. | | |
| Address | 2-8-17, Futaba, Shinagawa-Ku, Tokyo | | | | |

Stylish Low Rise Apt. in Futaba, near Nishiooi & Ooimachi stn.

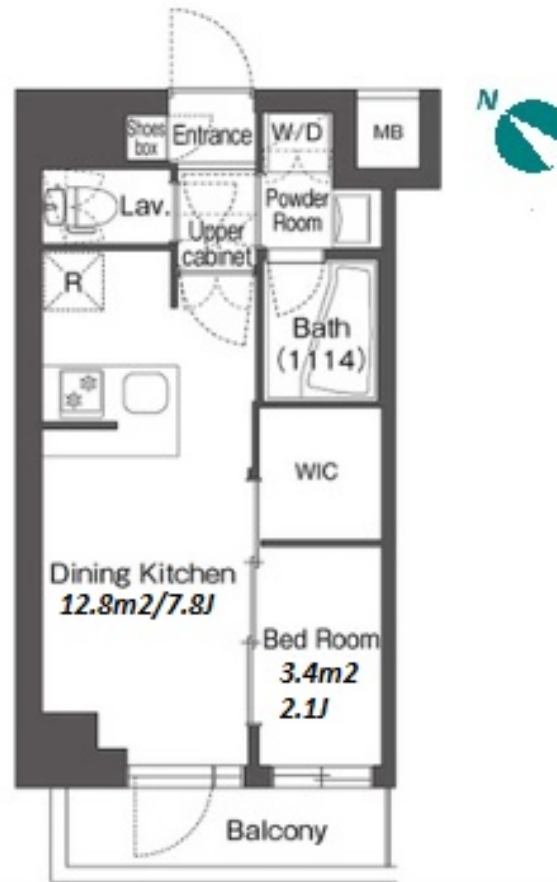
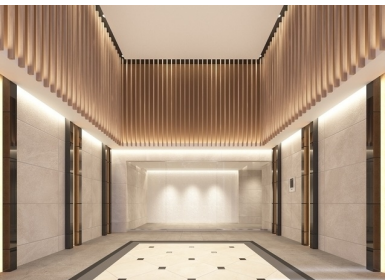

*The actual Layout & Size may differ slightly from this floor plans & pictures.

| Lease Conditions | | | |
|------------------|--|-----------|---|
| LAYOUT | 1 BR | | |
| SIZE | 25.95 m²/279.32 ft² | | |
| RENT | JPY 130,000 / month | | |
| Management Fee | JPY10,000/month | | |
| Deposit | 2 months | Key Money | - |
| Lease Term | Standard lease for 24 months | | |
| Available | Now | | |
| Renewal Fee | 1 month | | |
| Agent Fee | 1 month + tax | | |
| Other Info | Guarantor Company : TBC / No Key Money / Free rent / Auto lock / Air-Con / Separated Toilet / Balcony / Internet Included / Penalty Fee for Early Cancellation / Flooring / Bathroom dryer / WIC | | |

| Building Information | | | |
|----------------------|--|-----------------------|---------|
| Completion | Oct, 2023 | Earthquake Resistance | New |
| Structure | RC, 6 story | | |
| Car Parking | - | | |
| Bicycle Parking | (Included) | | |
| Music Instrument | - | Pet | Allowed |
| Facilities | Motorcycle Parking (JPY3,000 + tax / month) / Near Large Parks / Delivery box / Elevator / 24h Garbage Drop-off / Newly-built (~1 y/o) | | |

| Remarks |
|---|
| Renters Insurance : Required / Pet:additional deposit (1 month) / Pet : a small dog or up to two cats |



HOUSEREP TOKYO INC.

ハウズレップトーキョー株式会社

#301, 1-4-15, Hiroo, Shibuya-ku, Tokyo 150-0012, Japan

+81 (0)3 6427 5860

inquiry@housserep-tokyo.com

Transaction Type : Intermediate

Agent Fee : 1 month + tax

Website : www.housserep-tokyo.com

