

Sales Price	196,000,000 JPY	Access	Gotanda Station on	JR Yamanote Line	7 min. walk
Tax	None		Gotanda Station on	Toei Asakusa Line	5 min. walk

Property Name	TOKYU DWELL PRESTIGE IKEDAYAMA CLAREMONT
---------------	--

Cozy apartment in Higashigotanda

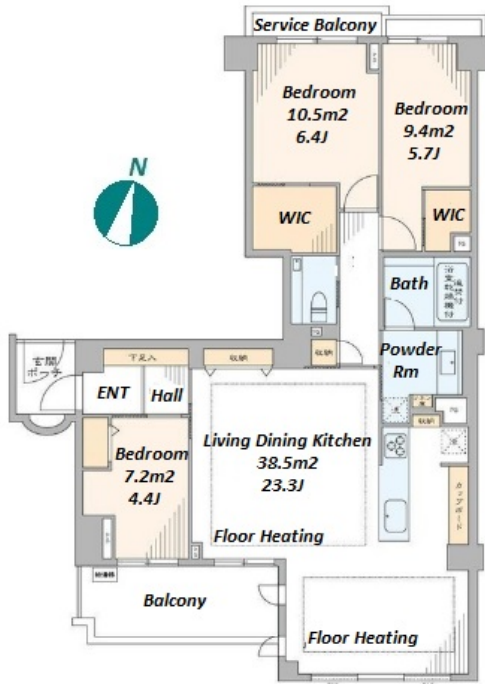

*The actual Layout & Size may differ slightly from this floor plans & pictures.

Address	2F, 5-8-8, Higashigotanda, Shinagawa-Ku, Tokyo
---------	--

Unit/Property Information			
LAYOUT	3 BR	Management Fee	JPY40,400/month
Unit Floor	2F~2F	Repair Fund	JPY21,550/month
Floor Size(sqm)	96.22 m ²	Other Fee	JPY2,701/month
Floor Size(sqft)	1035.7 ft ²	Total Monthly Fee	JPY64,651/month
Balcony	7.2 m ²	Current Status	Vacant
Facing	South	Hand Over	Now
Unit Facilities	Pet friendly, Auto lock, Renovated, Separated Toilet, Balcony, Nice Views, Flooring, Floor Heating, Dishwasher, WIC		

Building Information			
Structure	RC 5 floors above and 1 basement floors		
Total Units	21	Completion	Mar, 1998
Car Parking	(Not Included)	Pet	Negotiable
Developer Name	Tokyu Land Corporation		
Management company&Type	Nihon Housing Fully Outsourced / Day Shift		
Common Facility	Trunk Room (JPY2,000/ month), Janitor, Delivery box, Elevator, New Earthquake Resistance Standard, Close to Station, Low-rise		

Remarks
<Unit/Property Information> <Building Information> <Land Information>

Land Information			
Lot Area	-	Land lease term	-
Ownership Type	Ownership	Land lease fee	-
Co-owner's Share	-	Land Category	Residential
City Planning area	Urban Planning District		
Use Zoning	Category I exclusively low-rise residential zone		
Current Status	-	Bldg. to Land %	-
Hand Over	-	Floor to Land %	-
Private Road	-	Set Back	-
Other Conditions			