

FOR RENT

Property ID No. :151266

HOUSEREP TOKYO INC.

Website : www.houserep-tokyo.com

Property Name	RESIDIA TOWER KAMI-IKEBUKURO(PARK)	Unit No.	TYPE	Access	Ootsuka Station on JR Yamanote Line (10 min) Nishisugamo Station on Mita Line (14 min)
		PR-407	Apt.		
Address	1-37-5, Kamiikebukuro, Toshima-Ku, Tokyo				

Stylish Tower Residence near Ikebukuro

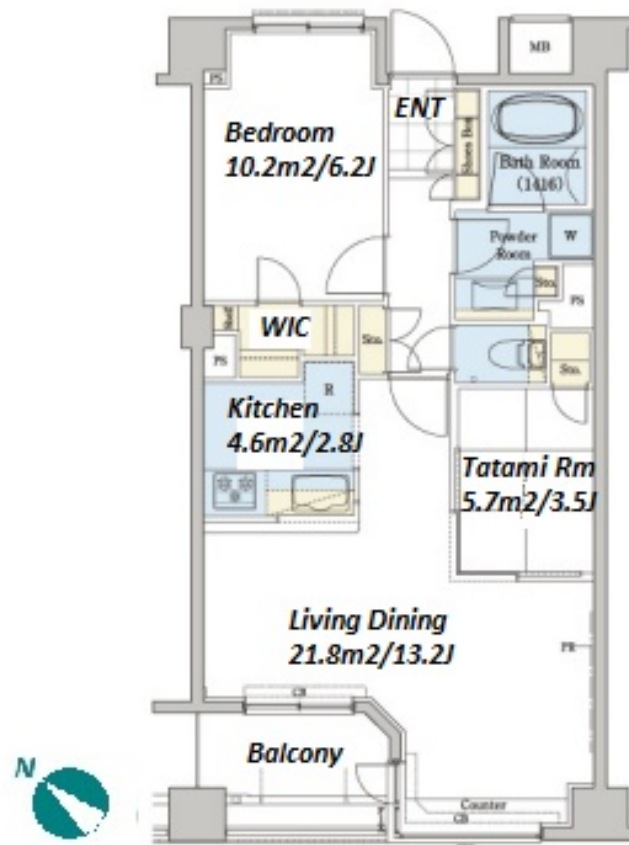

Lease Conditions			
LAYOUT	1 BR+J		
SIZE	58.11 m²/625.49 ft²		
RENT	JPY 215,000 / month		
Management Fee	JPY15,000/month		
Deposit	1 month	Key Money	-
Lease Term	Fixed term lease for 36 months		
Available	Now		
Renewal Fee	-		
Agent Fee	1 month + tax		
Other Info	Key Replacement Fee : JPY20,000 Tax not included / Guarantor Company : TBC / No Key Money / Auto lock / Air-Con / Separated Toilet / Balcony / Internet (Extra Charge) / Penalty Fee for Early Cancellation / Musical Instrument Negotiable / CS/CATV / Flooring / Bathroom dryer / WIC		

Building Information			
Completion	Feb, 2009	Earthquake Resistance	New
Structure	RC, 8 story		
Car Parking	JPY25,000 ~ 39,000 + tax / month		
Bicycle Parking	TBC		
Music Instrument	Negotiable	Pet	Allowed
Facilities	Front desk / Delivery box / Elevator		

*The actual Layout & Size may differ slightly from this floor plans & pictures.



HOUSEREP TOKYO INC.

ハウスレップトーキョー株式会社

#301, 1-4-15, Hiroo, Shibuya-ku, Tokyo 150-0012, Japan

+81 (0)3 6427 5860

inquiry@houserep-tokyo.com

Transaction Type : Intermediate

Agent Fee : 1 month + tax

Website : www.houserep-tokyo.com



Remarks
Fixed term lease : Re contract fee: 1 month of new Rent / Renters Insurance : Required / Internet subscription fee: 1,500yen+tax/month / Parking : 1 month for deposit / Pet:additional deposit (1 month) / Pet : a small dog or a cat