

FOR RENT

Property ID No. :151034

HOUSEREP TOKYO INC.

Website : www.houserrep-tokyo.com

Property Name	ROYAL PARKS TOYOSU	Unit No.	TYPE	Access	Toyosu Station on Yurakucho Line (5 min) Toyosu Station on (7 min)
		1203	Apt.		
Address	3-5-21, Toyosu, Koto-Ku, Tokyo				

Luxury Residence in Toyosu / Tokyo Bay Area

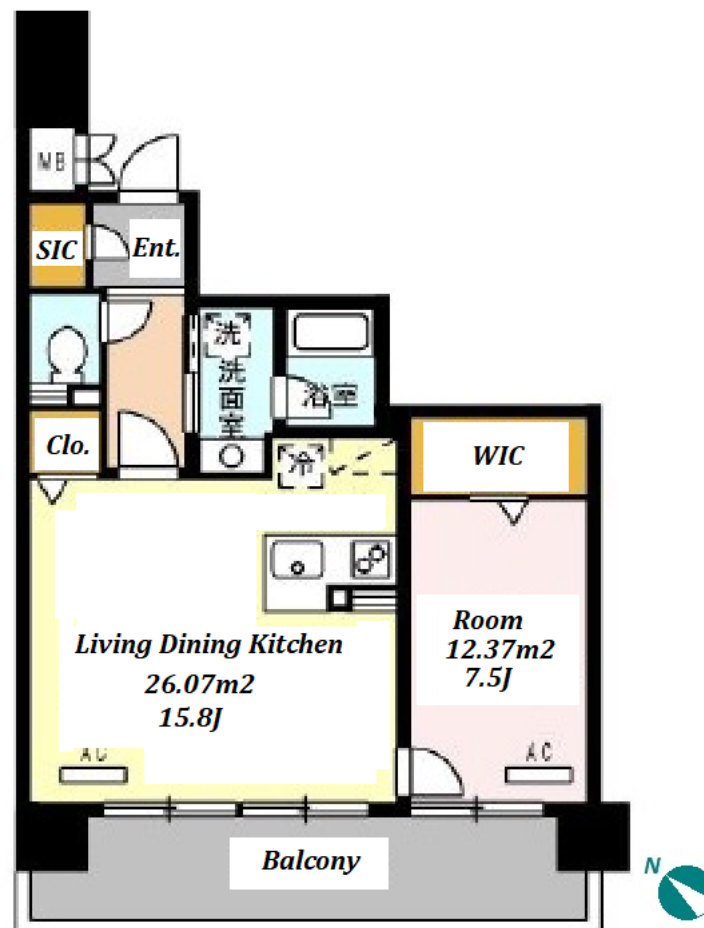

*The actual Layout & Size may differ slightly from this floor plans & pictures.

Lease Conditions			
LAYOUT	1 BR		
SIZE	56.18 m ² /604.71 ft ²		
RENT	JPY 225,000 / month		
Management Fee	JPY14,000/month		
Deposit	2 months	Key Money	1 month
Lease Term	Fixed term lease for 60 months		
Available	End, Jan, 2024		
Renewal Fee	-		
Agent Fee	1 month + tax		
Other Info	Guarantor Company : TBC / Auto lock / Air-Con / Separated Toilet / Balcony / BBQ place / Flooring / Floor Heating / Bathroom dryer		

Building Information			
Completion	Feb, 2007	Earthquake Resistance	New
Structure	RC, 14 story		
Car Parking	TBC		
Bicycle Parking	(Included)		
Music Instrument	-	Pet	Negotiable
Facilities	Motorcycle Parking (JPY2,000/ month) / Trunk Room (JPY7,000 ~ 14,000/ month) / Within 20 min to Tokyo station by car / Near Large Parks / Designer's / Front desk / Concierge / Delivery box / Elevator		

Remarks
Renters Insurance : Required / Key replacement fee: TBC



HOUSEREP TOKYO INC.

ハウスレップトーキョー株式会社

#301, 1-4-15, Hiroo, Shibuya-ku, Tokyo 150-0012, Japan

+81 (0)3 6427 5860

inquiry@houserrep-tokyo.com

Transaction Type : Intermediate

Agent Fee : 1 month + tax

Website : www.houserrep-tokyo.com

