

Property Name	SANT CORE MEGURO	Unit No.	TYPE	Access	Meguro Station on JR Yamanote Line (9 min)
		101	Apt.		
Address	1-24-5, Meguro, Meguro-Ku, Tokyo				

## Vintage Low-rise Apt. in Meguro

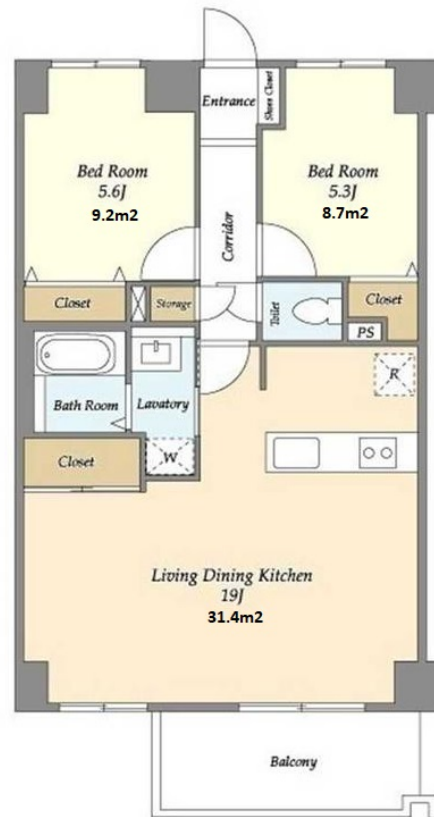

Lease Conditions		
LAYOUT	2 BR	
SIZE	65.16 m²/701.37 ft²	
RENT	JPY 277,000 / month	
Management Fee	JPY8,000/month	
Deposit	2 months	Key Money -
Lease Term	Standard lease for 24 months	
Available	Now	
Renewal Fee	1 month	
Agent Fee	1 month + tax	
Other Info	Key Replacement Fee : JPY30,000 Tax not included / Guarantor Company : TBC / No Key Money / Free rent / Auto lock / Renovated / Air-Con / Separated Toilet / Balcony / Penalty Fee for Early Cancellation / Flooring / Dishwasher / Bathroom dryer	

Building Information			
Completion	Jan, 2002	Earthquake Resistance	New
Structure	RC, 4 story		
Car Parking	TBC		
Bicycle Parking	for 2 spaces ( Included )		
Music Instrument	-	Pet	N/A
Facilities	Trunk Room (( Included )) / Elevator / Low-rise		



\*The actual Layout & Size may differ slightly from this floor plans & pictures.



# HOUSEREP TOKYO INC.

ハウスレップトーキョー株式会社

#301, 1-4-15, Hiroo, Shibuya-ku, Tokyo 150-0012, Japan

+81 (0)3 6427 5860

inquiry@housserep-tokyo.com

Transaction Type : Intermediate

Agent Fee : 1 month + tax

Website : www.housserep-tokyo.com



Remarks
Renters Insurance : Required