

Property Name	KOLET NISHIARAIHONCHO #13	Unit No.	TYPE	Access	Nishiarai Station on Tobu Isesaki Line (16 min)
			House		
Address	4-8-7, Nishiaraihoncho, Adachi-Ku, Tokyo				

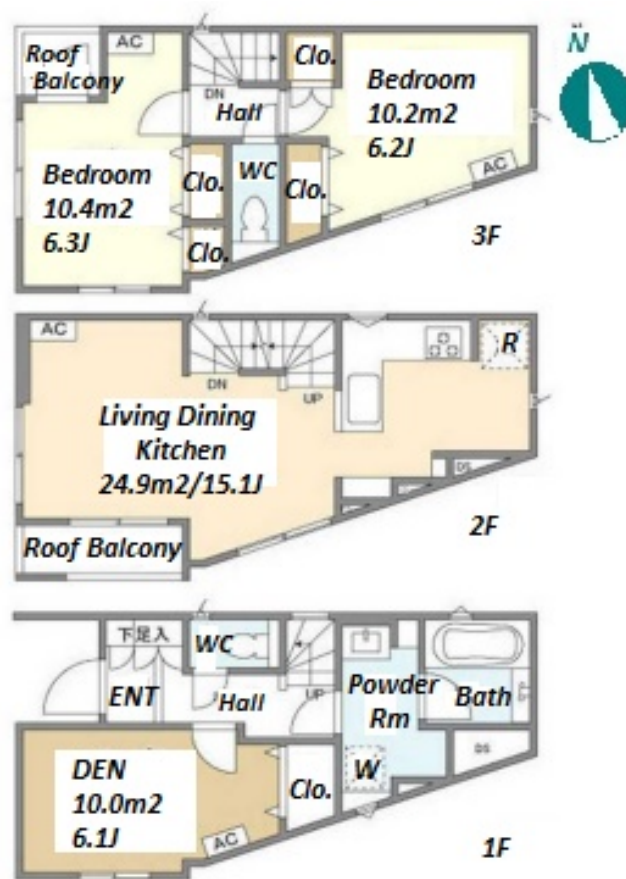
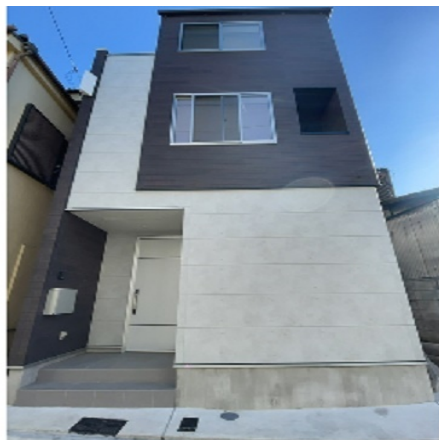

## Lease Conditions

LAYOUT	2 BR+Den		
SIZE	82.14 m <sup>2</sup> /884.14 ft <sup>2</sup>		
RENT	JPY 197,000 / month		
Management Fee	-		
Deposit	2 months	Key Money	-
Lease Term	Standard lease for 24 months		
Available	Now		
Renewal Fee	1 month		
Agent Fee	1 month + tax		
Other Info	Guarantor Company : TBC / No Key Money / Air-Con / Separated Toilet / Internet (Extra Charge) / Penalty Fee for Early Cancellation / Musical Instrument Negotiable / Roof Balcony / Flooring / Dishwasher / Bathroom dryer / 2 Toilets		

## Building Information

Completion	Oct, 2022	Earthquake Resistance	New
Structure	Wooden, 3 story		
Car Parking	-		
Bicycle Parking	-		
Music Instrument	Negotiable	Pet	Negotiable
Facilities	House / Delivery box / Newly-built (~7 y/o)		

## Remarks

Renters Insurance : Required

\*The actual Layout &amp; Size may differ slightly from this floor plans &amp; pictures.



HOUSEREP TOKYO INC.

ハウスレップトーキョー株式会社

#301, 1-4-15, Hiroo, Shibuya-ku, Tokyo 150-0012, Japan

+81 (0)3 6427 5860 inquiry@housserep-tokyo.com

Transaction Type : Intermediate

Agent Fee : 1 month + tax

Website : www.housserep-tokyo.com

