

Property Name	MINAMIAZABU M HOUSE	Unit No.	TYPE	Access	Shirokanetakanawa Station on Mita Line (9 min) Shirokanetakanawa Station on Namboku Line (9 min) Azabujuban Station on Namboku Line (10 min)
			House		
Address	2-9-26, Minamiazabu, Minato-Ku, Tokyo				

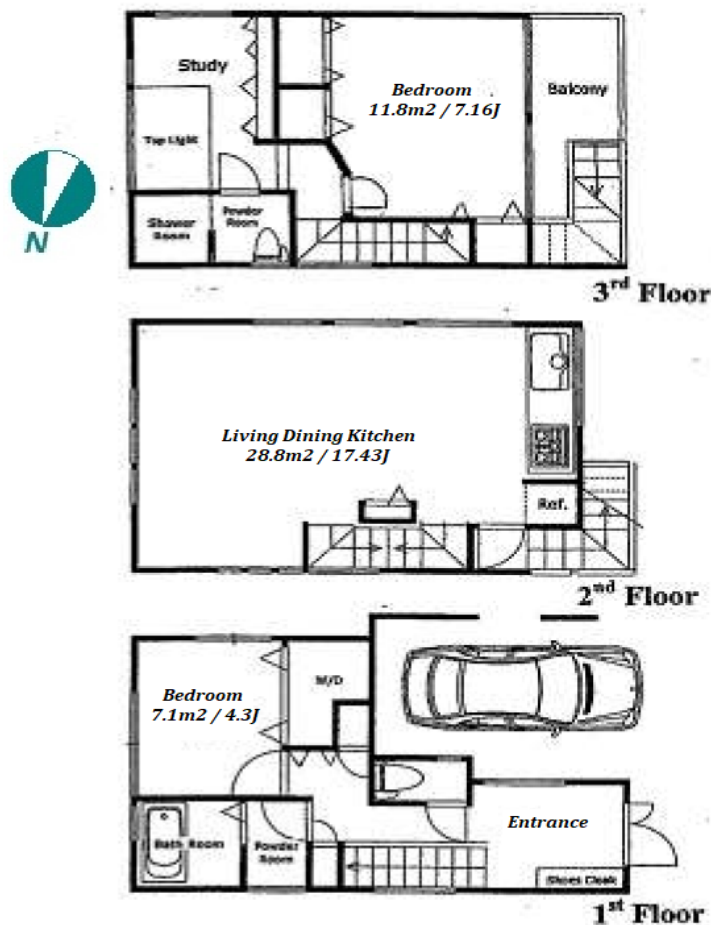
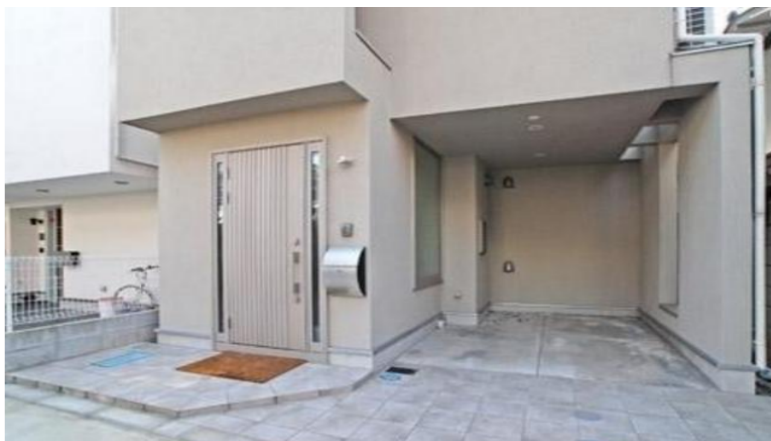

*The actual Layout & Size may differ slightly from this floor plans & pictures.

Lease Conditions			
LAYOUT	2 BR+S		
SIZE	97.97 m ² /1054.54 ft ²		
RENT	JPY 550,000 / month		
Management Fee	-		
Deposit	3 months	Key Money	1 month
Lease Term	Fixed term lease for 36 months		
Available	Now		
Renewal Fee	-		
Agent Fee	1 month + tax		
Other Info	Fridge / Air-Con / Separated Toilet / Internet (Extra Charge) / Flooring / Floor Heating / Curtain / Washer / Dryer / Dishwasher / Oven / Large Dog Friendly / 2 Toilets		

Building Information			
Completion	Oct, 2006	Earthquake Resistance	New
Structure	Wooden, 3 story		
Car Parking	for 1 space (Included)		
Bicycle Parking	-		
Music Instrument	-	Pet	
Facilities	House / Within 20 min to Tokyo station by car / Near Large Parks		

Remarks
Fixed term lease : Re contract fee: 1 month of new Rent / Renters Insurance : Required / Parking : Small-size car only / Pet:additional deposit (1 month) + depreciation fee (1 month)



HOUSEREP TOKYO INC.

ハウスレプトーキョー株式会社

#301, 1-4-15, Hiroo, Shibuya-ku, Tokyo 150-0012, Japan

+81 (0)3 6427 5860

inquiry@houserep-tokyo.com

Transaction Type : Intermediate

Agent Fee : 1 month + tax

Website : www.houserep-tokyo.com

