

FOR RENT

Property ID No. :146828

HOUSEREP TOKYO INC.

Website : www.houserep-tokyo.com

Property Name	JEUNESSE	Unit No.	TYPE	Access	Nishioojima Station on Toei Shinjuku Line (12 min)
		803	Apt.		
Address	1-3-43, Kitasuna, Koto-Ku, Tokyo				

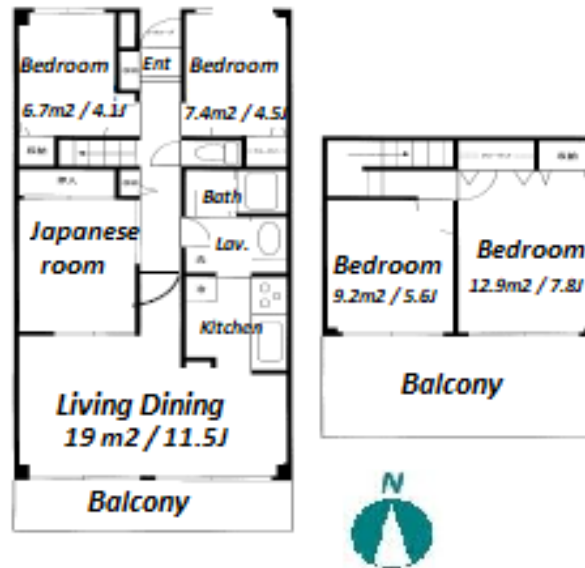

Lease Conditions			
LAYOUT	4 BR+J		
SIZE	100.77 m <sup>2</sup> /1084.67 ft <sup>2</sup>		
RENT	JPY 239,000 / month		
Management Fee	JPY9,000/month		
Deposit	2 months	Key Money	-
Lease Term	Standard lease for 24 months		
Available	Now		
Renewal Fee	-		
Agent Fee	1 month + tax		
Other Info	Key Replacement Fee : JPY20,000 Tax not included / Separated Toilet / Balcony / Loft/Maisonnette / Penalty Fee for Early Cancellation		

Building Information			
Completion	Apr, 1990	Earthquake Resistance	New
Structure	RC, 9 story		
Car Parking	for 1 space JPY35,000 + tax / month		
Bicycle Parking	-		
Music Instrument	-	Pet	-
Facilities	Motorcycle Parking (JPY4,000 + tax / month) / Janitor / Delivery box / Elevator / 24h Garbage Drop-off		

Remarks
Renters Insurance : Required

\*The actual Layout &amp; Size may differ slightly from this floor plans &amp; pictures.



HOUSEREP TOKYO INC.

ハウスレップトーキョー株式会社

#301, 1-4-15, Hiroo, Shibuya-ku, Tokyo 150-0012, Japan

+81 (0)3 6427 5860 inquiry@houserep-tokyo.com

Transaction Type : Intermediate

Agent Fee : 1 month + tax

Website : www.houserep-tokyo.com

