

Property Name	URBANEX GINZA HIGASHI II	Unit No.	TYPE	Access	Hacchoubori Station on JR Keiyo Line (5 min) Hacchoubori Station on Hibiya Line (5 min) Shinntomichou Station on Yurakucho Line (10 min)
		401	Apt.		
Address	1-12-3, Minato, Chuo-Ku, Tokyo				

Mid-rise Apt. in Hatchobori, near Ginza

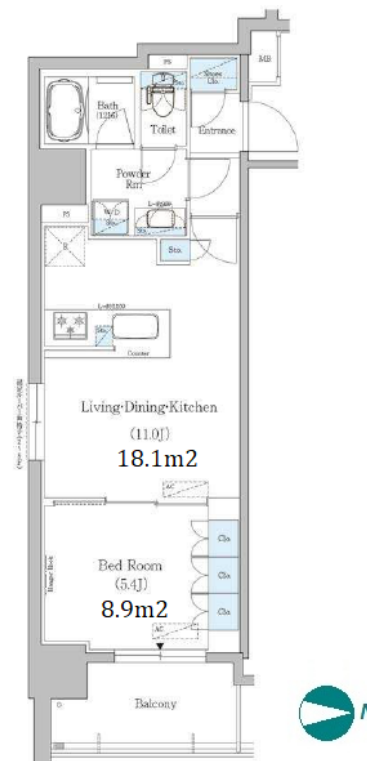

Lease Conditions			
LAYOUT	1 BR		
SIZE	40.2 m²/432.7 ft²		
RENT	JPY 190,000 / month		
Management Fee	JPY15,000/month		
Deposit	1 month	Key Money	-
Lease Term	Standard lease for 24 months		
Available	End, Apr, 2024		
Renewal Fee	1 month		
Agent Fee	1 month + tax		
Other Info	Key Replacement Fee : JPY20,000 Tax not included / Guarantor Company : TBC / No Key Money / Auto lock / Air-Con / Separated Toilet / Balcony / Penalty Fee for Early Cancellation / Flooring / Bathroom dryer / Corner Unit		

Building Information			
Completion	Feb, 2019	Earthquake Resistance	New
Structure	RC, 10 story		
Car Parking	-		
Bicycle Parking	for 1 space JPY500 + tax / month		
Music Instrument	-	Pet	-
Facilities	Delivery box / Elevator / Newly-built (~7 y/o)		

*The actual Layout & Size may differ slightly from this floor plans & pictures.



HOUSEREP TOKYO INC.

ハウスレップトーキョー株式会社

#301, 1-4-15, Hiroo, Shibuya-ku, Tokyo 150-0012, Japan

+81 (0)3 6427 5860 inquiry@housserep-tokyo.com

Transaction Type : Intermediate

Agent Fee : 1 month + tax

Website : www.housserep-tokyo.com



Remarks
Renters Insurance : Required