

Property Name	PARK AXIS TSUKISHIMA MATURE STYLE	Unit No.	TYPE	Access	Tsukishima Station on Oedo Line (1 min) Tsukishima Station on Yurakucho Line (1 min)
		404	Apt.		
Address	1-3-12, Tsukishima, Chuo-Ku, Tokyo				

## Luxury Serviced Residence in Water Front "Tsukishima" area

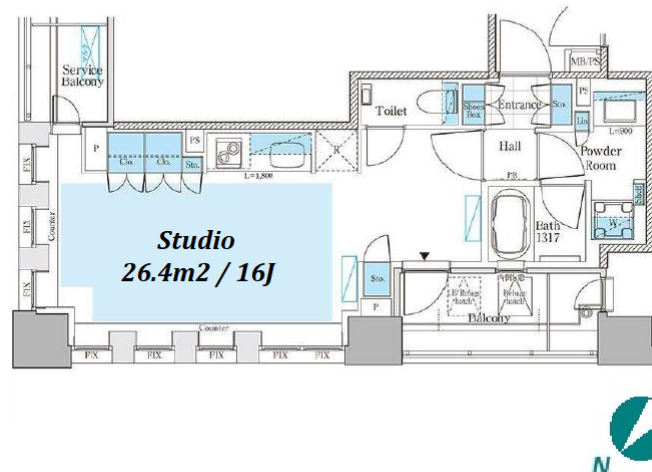

Lease Conditions			
LAYOUT	Studio		
SIZE	40.08 m <sup>2</sup> /431.41 ft <sup>2</sup>		
RENT	JPY 210,000 / month		
Management Fee	-		
Deposit	2 months	Key Money	1 month
Lease Term	Fixed term lease for 24 months		
Available	End, May, 2024		
Renewal Fee	-		
Agent Fee	1 month + tax		
Other Info	Key Replacement Fee : JPY15,000 Tax not included / Guarantor Company : TBC / Auto lock / Air-Con / Separated Toilet / Balcony / Internet (Extra Charge) / Penalty Fee for Early Cancellation / Musical Instrument Negotiable / Flooring / IH Stoves / Dishwasher / Bathroom dryer		

Building Information			
Completion	Oct, 2015	Earthquake Resistance	New
Structure	RC, 12 story		
Car Parking	N/A		
Bicycle Parking	for 1 space ( Included )		
Music Instrument	Negotiable	Pet	Allowed
Facilities	Motorcycle Parking (TBC) / Front desk / Janitor / Delivery box / Elevator		

\*The actual Layout & Size may differ slightly from this floor plans & pictures.



# HOUSEREP TOKYO INC.

ハウスレップトーキョー株式会社

#301, 1-4-15, Hiroo, Shibuya-ku, Tokyo 150-0012, Japan

+81 (0)3 6427 5860

inquiry@housserep-tokyo.com

Transaction Type : Intermediate

Agent Fee : 1 month + tax

Website : www.housserep-tokyo.com



Remarks
Renters Insurance : Required / Bicycle parking : Registration fee: JPY.2,000+tax / Pet:additional deposit ( 1 month ) / Pet : a small dog or a cat