

Property Name	PREDEAR COURT NISHIIKEBUKURO	Unit No.	TYPE	Access	Shiinamachi Station on Seibu Ikebukuro Line (5 min) Kanamechou Station on Fukutoshin Line (8 min) Ikebukuro Station on JR Yamanote Line (15 min)
		604	Apt.		
Address	4-27-8, Nishiikebukuro, Toshima-Ku, Tokyo				

Mid-rise Apt. in Ikebukuro, Easy access to Shinjuku / Shibuya / Ebisu

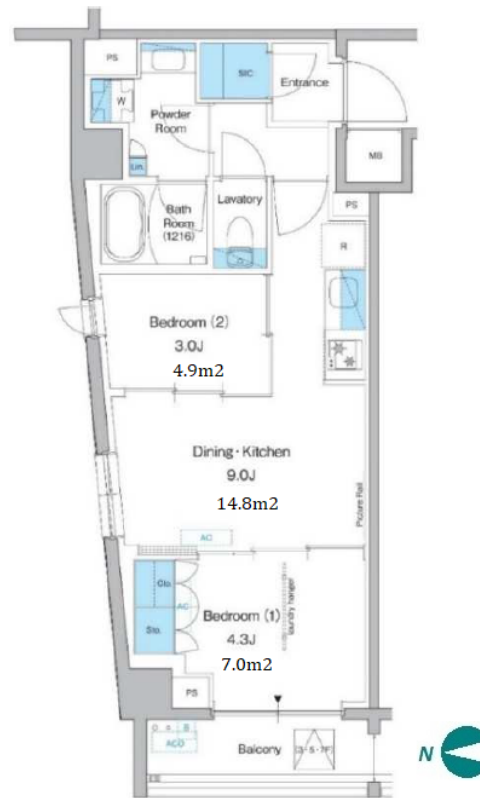

Lease Conditions			
LAYOUT	2 BR		
SIZE	41.27 m ² /444.22 ft ²		
RENT	JPY 190,000 / month		
Management Fee	JPY15,000/month		
Deposit	1 month	Key Money	1 month
Lease Term	Standard lease for 24 months		
Available	Now		
Renewal Fee	1 month		
Agent Fee	1 month + tax		
Other Info	Guarantor Company : TBC / Auto lock / Air-Con / Separated Toilet / Balcony / Internet Included / Penalty Fee for Early Cancellation / Flooring / Bathroom dryer		

Building Information			
Completion	Dec, 2022	Earthquake Resistance	New
Structure	RC, 7 story		
Car Parking	N/A		
Bicycle Parking	for 1 space (Included)		
Music Instrument	-	Pet	
Facilities	Delivery box / Elevator / Newly-built (~1 y/o)		

*The actual Layout & Size may differ slightly from this floor plans & pictures.



HOUSEREP TOKYO INC.

ハウスレップトーキョー株式会社

#301, 1-4-15, Hiroo, Shibuya-ku, Tokyo 150-0012, Japan

+81 (0)3 6427 5860 inquiry@housserrep-tokyo.com

Transaction Type : Intermediate

Agent Fee : 1 month + tax

Website : www.housserrep-tokyo.com



Remarks
Renters Insurance : Required / Tenant support fee: 15,000yen+tax/2 years. / Bicycle parking : Registration fee: 3,000yen+tax. / Pet:additional deposit (1 month)