

Property Name	PARK AXIS TAKINOGAWA	Unit No.	TYPE	Access	Nishisugamo Station on Mita Line (10 min) Itabashi Station on JR Saikyo Line (14 min)
		603	Apt.		
Address	3-48-11, Takinogawa, Kita-Ku, Tokyo				

Mid-rise Apt. in Takinogawa, near Itabashi / Sugamo

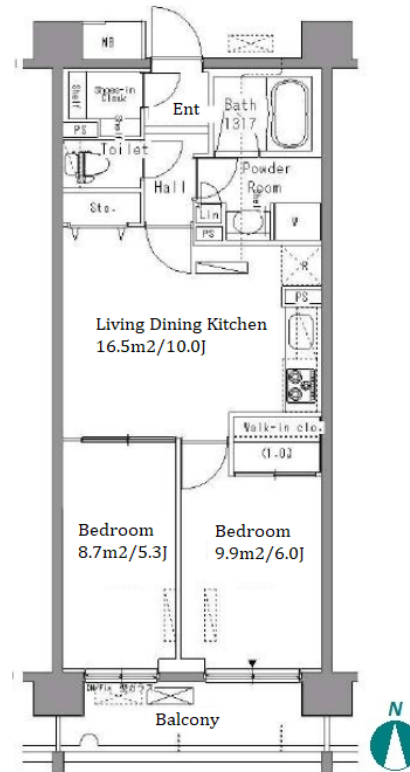

Lease Conditions			
LAYOUT	2 BR		
SIZE	50.29 m ² /541.31 ft ²		
RENT	JPY 198,000 / month		
Management Fee	JPY10,000/month		
Deposit	2 months	Key Money	1 month
Lease Term	Standard lease for 24 months		
Available	Early, May, 2024		
Renewal Fee	1 month		
Agent Fee	1 month + tax		
Other Info	Key Replacement Fee : JPY15,000 Tax not included / Guarantor Company : TBC / Auto lock / Air-Con / Separated Toilet / Balcony / Internet (Extra Charge) / Penalty Fee for Early Cancellation / Flooring / Bathroom dryer		

Building Information			
Completion	Apr, 2007	Earthquake Resistance	New
Structure	RC, 7 story		
Car Parking	N/A		
Bicycle Parking	for 1 space (Included)		
Music Instrument	-	Pet	
Facilities	Delivery box / Elevator		

Remarks
Renters Insurance : Required / Bicycle parking : registration fee : JPY2,000+tax / Pet:additional deposit (1 month)

*The actual Layout & Size may differ slightly from this floor plans & pictures.



HOUSEREP TOKYO INC.

ハウスレップトーキョー株式会社

#301, 1-4-15, Hiroo, Shibuya-ku, Tokyo 150-0012, Japan

+81 (0)3 6427 5860 inquiry@housserep-tokyo.com

Transaction Type : Intermediate

Agent Fee : 1 month + tax

Website : www.housserep-tokyo.com

