

Property Name	COMFORIA WASEDA	Unit No.	TYPE	Access	Ushigomeyanagichou Station on Oedo Line (5 min) Waseda Station on Tozai Line (8 min)
		115	Apt.		
Address	147, Bentencho, Shinjuku-Ku, Tokyo				

## Low Rise Apt in Waseda, Shinjuku

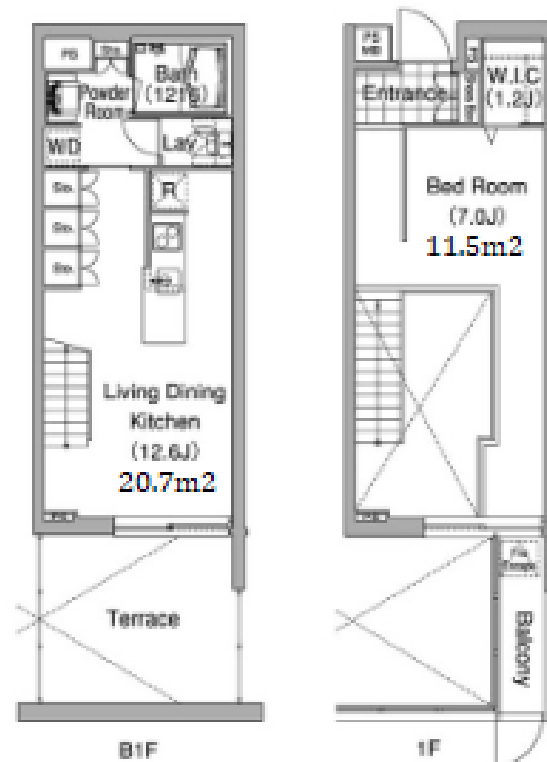

Lease Conditions	
LAYOUT	1 BR
SIZE	51.54 m <sup>2</sup> /554.77 ft <sup>2</sup>
RENT	JPY 182,000 / month
Management Fee	JPY12,000/month
Deposit	2 months
Key Money	-
Lease Term	Standard lease for 24 months
Available	Mid, Jul, 2024
Renewal Fee	1 month
Agent Fee	1 month + tax
Other Info	Key Replacement Fee : JPY20,000 Tax not included / Guarantor Company : TBC / No Key Money / Auto lock / Air-Con / Separated Toilet / Balcony / Loft/Maisonnette / Penalty Fee for Early Cancellation / Flooring / IH Stoves / Bathroom dryer / WIC

Building Information			
Completion	Apr, 2009	Earthquake Resistance	New
Structure	RC, 5 floors above		
Car Parking	N/A		
Bicycle Parking	extra charge		
Music Instrument	-	Pet	Negotiable
Facilities	Motorcycle Parking (extra charge) / Near Large Parks / Janitor / Delivery box / Elevator		

\*The actual Layout & Size may differ slightly from this floor plans & pictures.



# HOUSEREP TOKYO INC.

ハウズレップトーキョー株式会社

#301, 1-4-15, Hiroo, Shibuya-ku, Tokyo 150-0012, Japan

+81 (0)3 6427 5860

inquiry@housserep-tokyo.com

Transaction Type : Intermediate

Agent Fee : 1 month + tax

Website : www.housserep-tokyo.com



Remarks
Bicycle parking : Registration fee: JPY.1,000+tax