

Property Name	URBANEX CHIYODA AWAJICHO	Unit No.	TYPE	Access	Ogawamachi Station on Toei Shinjuku Line (1 min) Jinnbouchou Station on Mita Line (8 min) Kannda Station on JR Yamanote Line (10 min)
		1206	Apt.		
Address	1-7-4, Kandaogawamachi, Chiyoda-Ku, Tokyo				

New Apt near Kanda, Chiyoda

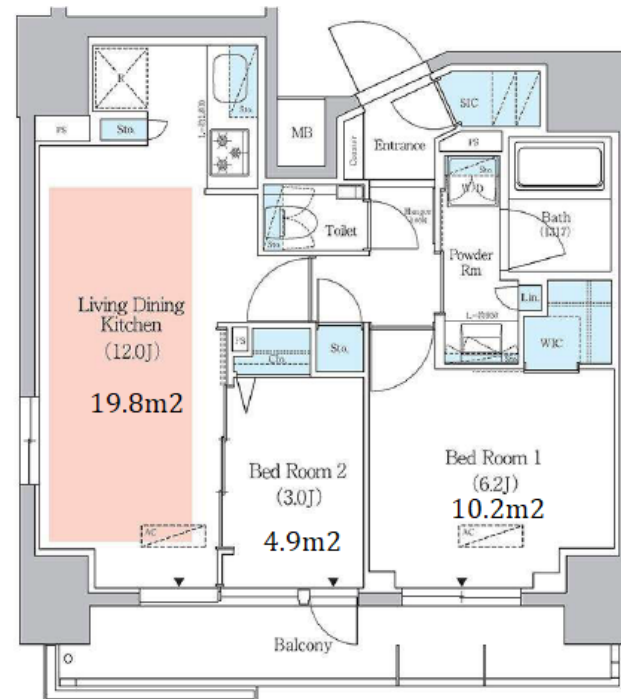

Lease Conditions		
LAYOUT	2 BR	
SIZE	51.69 m²/556.38 ft²	
RENT	JPY 320,000 / month	
Management Fee	JPY20,000/month	
Deposit	2 months	Key Money -
Lease Term	Standard lease for 24 months	
Available	End, May, 2024	
Renewal Fee	1 month	
Agent Fee	1 month + tax	
Other Info	Key Replacement Fee : JPY20,000 Tax not included / Guarantor Company : TBC / No Key Money / Auto lock / Air-Con / Separated Toilet / Balcony / Penalty Fee for Early Cancellation / Flooring / Floor Heating	

Building Information			
Completion	Mar, 2022	Earthquake Resistance	New
Structure	RC, 13 story		
Car Parking	TBC		
Bicycle Parking	JPY550 + tax / month		
Music Instrument	-	Pet	-
Facilities	Within 20 min to Tokyo station by car / Delivery box / Elevator / Close to Station / Newly-built (~7 y/o)		

Remarks
Renters Insurance : Required

*The actual Layout & Size may differ slightly from this floor plans & pictures.



HOUSEREP TOKYO INC.

ハウスレップトーキョー株式会社

#301, 1-4-15, Hiroo, Shibuya-ku, Tokyo 150-0012, Japan

+81 (0)3 6427 5860

inquiry@housserep-tokyo.com

Transaction Type : Intermediate

Agent Fee : 1 month + tax

Website : www.housserep-tokyo.com

