

Property Name	PARK FLATS GAKUGEIDAIGAKU	Unit No.	TYPE	Access	Gakugeidaigaku Station on Toyoko Line (10 min)
		302	Apt.		
Address	3-1-1, Nozawa, Setagaya-Ku, Tokyo				

## Apartment in Gakugeidaigaku (Supermarket on 1F)

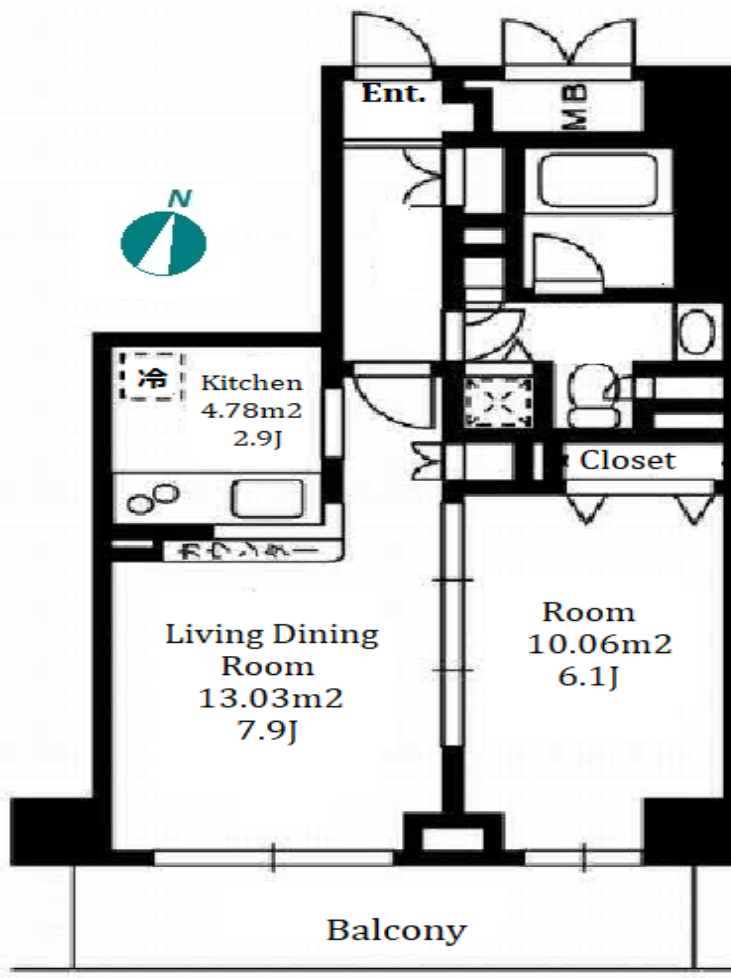
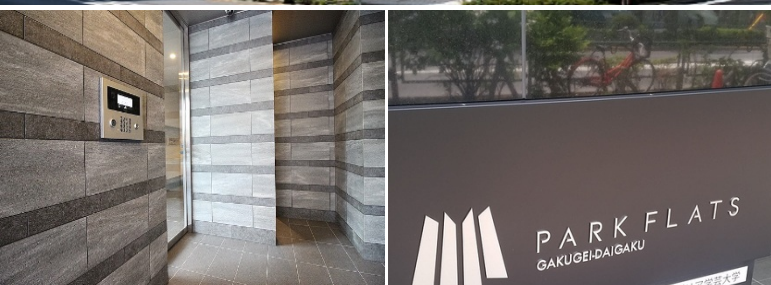

\*The actual Layout & Size may differ slightly from this floor plans & pictures.

Lease Conditions	
LAYOUT	1 BR
SIZE	41.99 m²/451.97 ft²
RENT	JPY 172,000 / month
Management Fee	JPY 15,000/month
Deposit	2 months
Key Money	1 month
Lease Term	Standard lease for 24 months
Available	Now
Renewal Fee	1 month
Agent Fee	1 month + tax
Other Info	Key Replacement Fee : JPY 36,000 Tax not included / Guarantor Company : TBC / Auto lock / Air-Con / Separated Toilet / Balcony / Flooring / Bathroom dryer

Building Information			
Completion	Sep, 2009	Earthquake Resistance	New
Structure	RC, 7 floors above		
Car Parking	N/A		
Bicycle Parking	N/A		
Music Instrument	-	Pet	-
Facilities	Delivery box / Elevator / Security		

Remarks
Renters Insurance : Required



HOUSE REP TOKYO INC.

ハウズレップトーキョー株式会社

#301, 1-4-15, Hiroo, Shibuya-ku, Tokyo 150-0012, Japan

+81 (0)3 6427 5860

inquiry@housserrep-tokyo.com

Transaction Type : Intermediate

Agent Fee : 1 month + tax

Website : www.housserrep-tokyo.com

