

Property Name	PARK AXIS TATSUMI STAGE	Unit No.	1104	TYPE	Apt.	Access	Tatsumi Station on Yurakucho Line (5 min) Shin-kiba Station on Rinkai Line (15 min)
Address	2-1-56, Tatsumi, Koto-Ku, Tokyo						

Mid-rise apt. in Tastumi near Shinkiba area

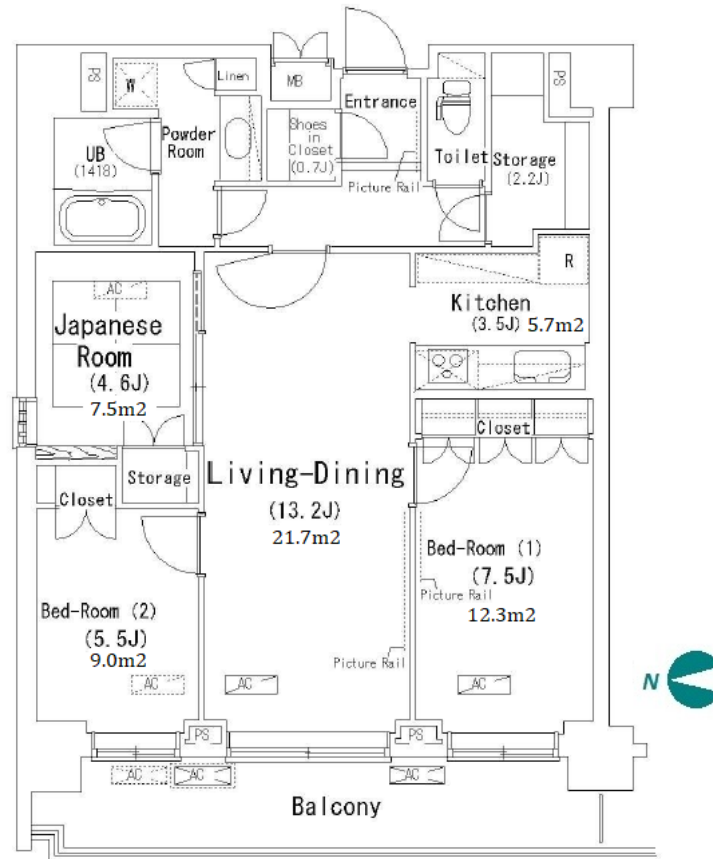

\*The actual Layout & Size may differ slightly from this floor plans & pictures.

Lease Conditions			
LAYOUT	3 BR		
SIZE	81.54 m <sup>2</sup> /877.68 ft <sup>2</sup>		
RENT	JPY 240,000 / month		
Management Fee	JPY15,000/month		
Deposit	2 months	Key Money	1 month
Lease Term	Standard lease for 24 months		
Available	Now		
Renewal Fee	1 month		
Agent Fee	1 month + tax		
Other Info	Key Replacement Fee : JPY15,000 Tax not included / Guarantor Company : TBC / Auto lock / Air-Con / Separated Toilet / Balcony / Penalty Fee for Early Cancellation / Musical Instrument Negotiable / Flooring / Bathroom dryer		

Building Information			
Completion	Jan, 2008	Earthquake Resistance	New
Structure	RC, 13 story		
Car Parking	extra charge		
Bicycle Parking	TBC		
Music Instrument	Negotiable	Pet	Allowed
Facilities	Motorcycle Parking (TBC) / Near Large Parks / Janitor / Delivery box / Elevator / Security		

Remarks
Renters Insurance : Required / Bicycle parking : Registration fee: JPY2,000+tax / Pet:additional deposit ( 1 month ) / Pet : a small dog or up to two cats



HOUSEREP TOKYO INC.

ハウスレップトーキョー株式会社

#301, 1-4-15, Hiroo, Shibuya-ku, Tokyo 150-0012, Japan

+81 (0)3 6427 5860 inquiry@housserep-tokyo.com

Transaction Type : Intermediate

Agent Fee : 1 month + tax

Website : www.housserep-tokyo.com

