

Property Name	PARK AXIS OCHANOMIZU STAGE	Unit No.	TYPE	Access	Suehirochou Station on <b>Ginza</b> Line (6 min) Yushima Station on <b>Chiyoda</b> Line (6 min) Ochanomizu Station on <b>JR Chuo</b> Line Rapid Service (8 min) Akihabara Station on <b>JR Yamanote</b> Line (13 min)
		206	Apt.		
Address	3-2-14, Yushima, Bunkyo-Ku, Tokyo				

## Lease Conditions

<b>LAYOUT</b>	1 BR		
<b>SIZE</b>	41.39 m <sup>2</sup> /445.51 ft <sup>2</sup>		
<b>RENT</b>	JPY 179,000 / month		
<b>Management Fee</b>	JPY10,000/month		
<b>Deposit</b>	2 months	<b>Key Money</b>	1 month
<b>Lease Term</b>	Standard lease for 24 months		
<b>Available</b>	Now		
<b>Renewal Fee</b>	1 month		
<b>Agent Fee</b>	1 month + tax		
<b>Other Info</b>	Key Replacement Fee : JPY15,000 Tax not included / Guarantor Company : TBC / Auto lock / Air-Con / Separated Toilet / Balcony / Penalty Fee for Early Cancellation / Musical Instrument Negotiable / CS/CATV / Flooring / Floor Heating / Bathroom dryer		

## Building Information

<b>Completion</b>	Feb, 2006	<b>Earthquake Resistance</b>	New
<b>Structure</b>	RC, 14 floors above		
<b>Car Parking</b>	extra charge		
<b>Bicycle Parking</b>	for 1 space ( Included )		
<b>Music Instrument</b>	Negotiable	<b>Pet</b>	Allowed
<b>Facilities</b>	Motorcycle Parking (TBC) / Within 20 min to Tokyo station by car / Janitor / Delivery box / Elevator / Security		

## Remarks

# Mid-rise Apt. in Ochanomizu, near Akihabara



Renters Insurance : Required / Bicycle parking : Registration sticker  
fee: 2,000+tax / Pet: additional deposit ( 1 month ) / Pet : up to two small  
dogs/ No cat

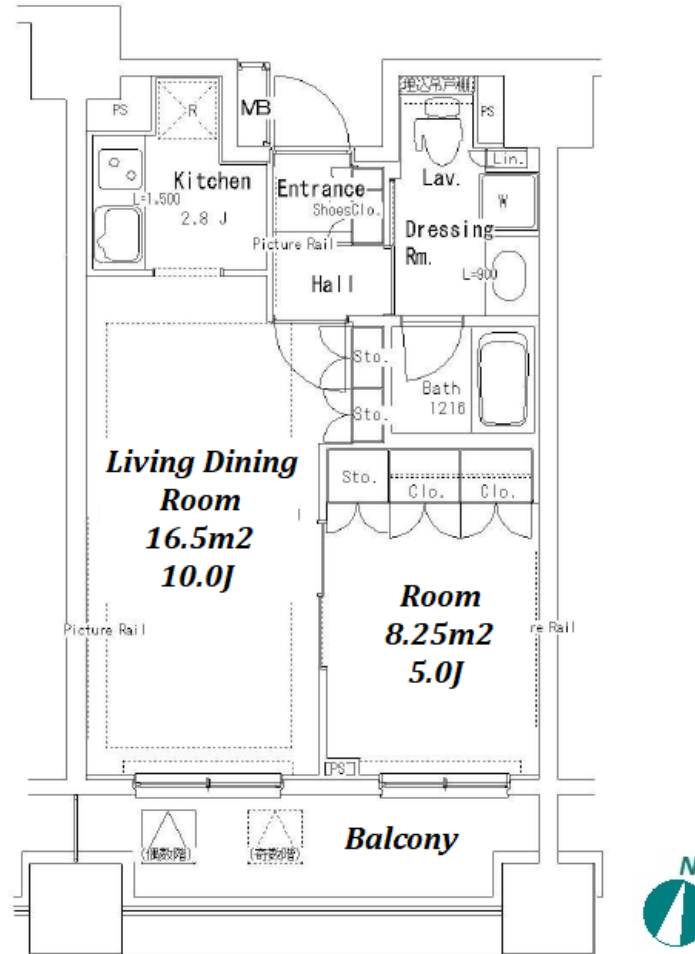

\*The actual Layout & Size may differ slightly from this floor plans & pictures.



**HOUSEREP TOKYO INC.**

ハウズレップトーキョー株式会社

#301, 1-4-15, Hiroo, Shibuya-ku, Tokyo 150-0012, Japan

+81 (0)3 6427 5860 inquiry@houserep-tokyo.com

Transaction Type : Intermediate

Agent Fee : 1 month + tax

Website : [www.houserep-tokyo.com](http://www.houserep-tokyo.com)

