

Property Name	Deux Tours Canal&Spa	Unit No.	TYPE	Access	Kachidoki Station on Oedo Line (9 min)
		E4512	Apt.		
Address	3-13-1, Harumi, Chuo-Ku, Tokyo				

## Modern Luxury Tower SOHO Space in Tokyo Bay Area, Kachidoki

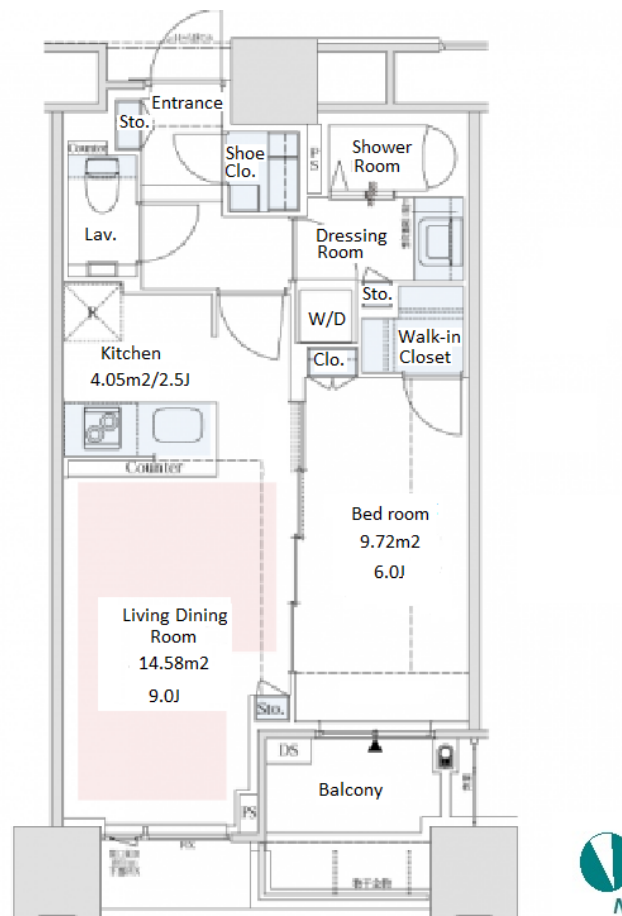
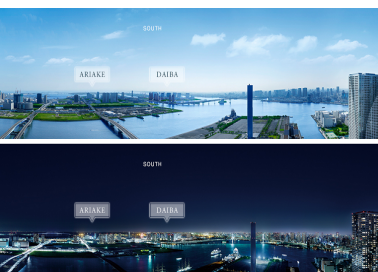

Lease Conditions	
LAYOUT	1 BR
SIZE	42.8 m <sup>2</sup> /460.69 ft <sup>2</sup>
RENT	JPY 271,700 / month
Management Fee	-
Deposit	2 months
Key Money	-
Lease Term	Fixed term lease for 24 months
Available	Negotiable
Renewal Fee	-
Agent Fee	1 month + tax
Other Info	Depreciation : 1 month / Office Use Allowed / No Key Money / Auto lock / Separated Toilet / Balcony / SOHO Allowed

Building Information			
Completion	Sep, 2015	Earthquake Resistance	New
Structure	RC, 52 floors above		
Car Parking	JPY27,000 ~ 42,000/ month		
Bicycle Parking	JPY150 ~ 500/ month		
Music Instrument	-	Pet	Negotiable
Facilities	Motorcycle Parking (JPY5,000 ~ 7,000/ month) / Gym (extra charge) / Within 20 min to Roppongi by train / Within 20 min to Tokyo station by car / Near Large Parks / pool / Front desk / Concierge / Delivery box / Elevator / Sky lounge		

Remarks
Renters Insurance : Required / *Rent : Taxable *Walkin Distance to Ginza area *Kids Room

\*The actual Layout & Size may differ slightly from this floor plans & pictures.



# HOUSEREP TOKYO INC.

ハウスレップトーキョー株式会社

#301, 1-4-15, Hiroo, Shibuya-ku, Tokyo 150-0012, Japan

+81 (0)3 6427 5860

inquiry@housserrep-tokyo.com

Transaction Type : Intermediate

Agent Fee : 1 month + tax

Website : www.housserrep-tokyo.com

