

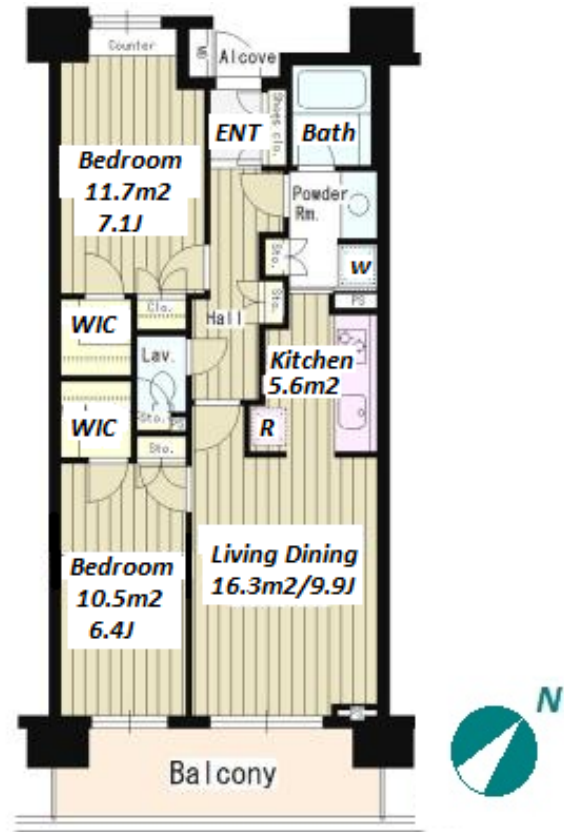

| | | | | | | | | | |
|---------------|--------------------------------------|-------------------------|--|----------|------|---------------------|--|-----------------------------------|--|
| FOR RENT | | Property ID No. :126928 | | | | HOUSEREP TOKYO INC. | | Website : www.housserep-tokyo.com | |
| Property Name | CLASSA MEGURO | | | Unit No. | TYPE | Access | Meguro Station on JR Yamanote Line (4 min) | | |
| | | | | 903 | Apt. | | | | |
| Address | 1-5-4, Shimomeguro, Meguro-Ku, Tokyo | | | | | | | | |

Cozy Apartment in Meguro, near Meguro River



*The actual Layout & Size may differ slightly from this floor plans & pictures.



HOUSEREP TOKYO INC.

ハウスレップトーキョー株式会社

#301, 1-4-15, Hiroo, Shibuya-ku, Tokyo 150-0012, Japan
 +81 (0)3 6427 5860 inquiry@housserep-tokyo.com

Transaction Type : Intermediate

Agent Fee : 1 month + tax

Website : www.housserep-tokyo.com



| Lease Conditions | | | |
|------------------------------|--|-----------------------|------------|
| LAYOUT | 2 BR | | |
| SIZE | 65.6 m²/706.11 ft² | | |
| RENT | JPY 315,000 / month | | |
| Management Fee | JPY10,000/month | | |
| Deposit | 1 month | Key Money | 1.5 months |
| Lease Term | Standard lease for 24 months | | |
| Available | Mid, Mar, 2024 | | |
| Renewal Fee | 1 month | | |
| Agent Fee | 1 month + tax | | |
| Other Info | Key Replacement Fee : JPY20,000 Tax not included / Guarantor Company : TBC / Auto lock / Air-Con / Separated Toilet / Balcony / Internet Included / Penalty Fee for Early Cancellation / Musical Instrument Negotiable / CS/CATV / Flooring / Floor Heating / Bathroom dryer / WIC | | |
| Building Information | | | |
| Completion | Aug, 2004 | Earthquake Resistance | New |
| Structure | SRC, 10 story | | |
| Car Parking | TBC | | |
| Bicycle Parking | for 1 space (Included) | | |
| Music Instrument | Negotiable | Pet | - |
| Facilities | Motorcycle Parking (TBC) / Front desk / Delivery box / Elevator | | |
| Remarks | | | |
| Renters Insurance : Required | | | |