

Property Name	RESIDIA ICHIGAYA SADOHARA	Unit No.	TYPE	Access	Ushigomekagurazaka Station on Oedo Line (6 min) Iidabashi Station on JR Chuo Line Rapid Service (8 min) Ichigaya Station on JR Chuo Line Rapid Service (9 min)
		S403	Apt.		
Address	3-19, Ichigayasadoharacho, Shinjuku-Ku, Tokyo				

## Luxury Low Rise Residence in Ichigaya / Kagurazaka

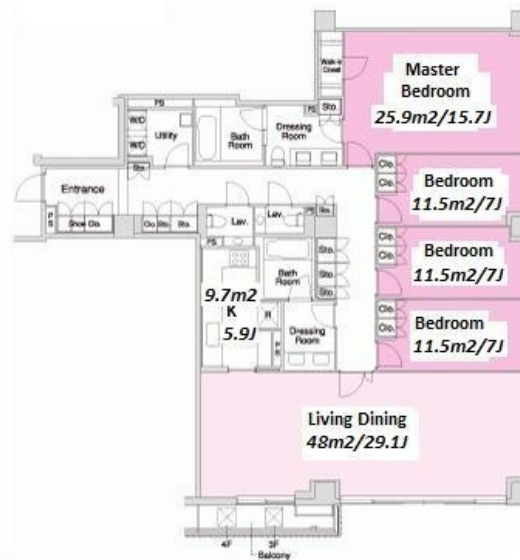

Lease Conditions	
LAYOUT	4 BR
SIZE	180.44 m <sup>2</sup> /1942.23 ft <sup>2</sup>
RENT	JPY 1,150,000 / month
Management Fee	-
Deposit	3 months
Key Money	-
Lease Term	Fixed term lease for 36 months
Available	Now
Renewal Fee	-
Agent Fee	1 month + tax
Other Info	Key Replacement Fee : JPY20,000 Tax not included / Guarantor Company : TBC / Auto lock / Fridge / Air-Con / Separated Toilet / Balcony / Penalty Fee for Early Cancellation / 2+ bathrooms / CS/CATV / Flooring / Carpet / Washer / Dryer / Dishwasher / Oven / Bathroom dryer / WIC / 2 Toilets

Building Information	
Completion	Dec, 2008
Earthquake Resistance	New
Structure	RC, 5 floors above
Car Parking	extra charge
Bicycle Parking	extra charge
Music Instrument	-
Pet	Allowed
Facilities	Motorcycle Parking (TBC) / Trunk Room (extra charge) / Within 20 min to Tokyo station by car / Near Large Parks / French Community / Front desk / Delivery box / Elevator / Low-rise

\*The actual Layout & Size may differ slightly from this floor plans & pictures.



# HOUSEREP TOKYO INC.

ハウズレップトーキョー株式会社

#301, 1-4-15, Hiroo, Shibuya-ku, Tokyo 150-0012, Japan

+81 (0)3 6427 5860

inquiry@housserrep-tokyo.com

Transaction Type : Intermediate

Agent Fee : 1 month + tax

Website : www.housserrep-tokyo.com



Remarks
Fixed term lease : Re-ccontract fee : 1 month / Renters Insurance : Required / Parking : 3 months deposit / Pet:additional deposit ( 1 month ) / Pet : a small dog or a cat