

Property Name	MY TOWER RESIDENCE	Unit No.	TYPE	Access	Yoyogi Station on JR Yamanote Line (3 min) Minamishinjuku Station on Odakyu Line (3 min) Shinjuku Station on JR Yamanote Line (8 min)
		1911	Apt.		
Address	1-53-1, Yoyogi, Shibuya-Ku, Tokyo				

Designer's Tower Mansion with Full Glass Windows at the Yoyogi Area

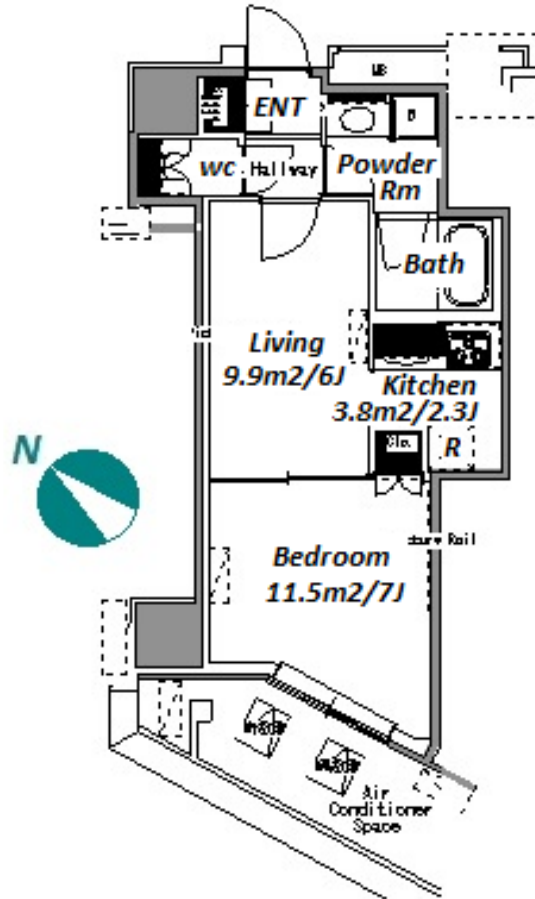

*The actual Layout & Size may differ slightly from this floor plans & pictures.

Lease Conditions			
LAYOUT	1 BR		
SIZE	36.74 m ² /395.46 ft ²		
RENT	JPY 206,000 / month		
Management Fee	JPY12,000/month		
Deposit	2 months	Key Money	1.5 months
Lease Term	Standard lease for 24 months		
Available	End, Aug, 2024		
Renewal Fee	1 month		
Agent Fee	1 month + tax		
Other Info	Key Replacement Fee : JPY20,000 Tax not included / Guarantor Company : TBC / Auto lock / Air-Con / Separated Toilet / Balcony / Penalty Fee for Early Cancellation / Musical Instrument Negotiable / Flooring / Bathroom dryer		

Building Information			
Completion	Feb, 2007	Earthquake Resistance	New
Structure	RC, 27 floors above and 3 basement floors		
Car Parking	JPY48,000 + tax / month		
Bicycle Parking	for 1 space (Included)		
Music Instrument	Negotiable	Pet	-
Facilities	Motorcycle Parking (TBC) / Front desk / Janitor / Delivery box / Elevator / Close to Station / High-rise		

Remarks
Renters Insurance : Required



HOUSEREP TOKYO INC.

ハウスレップトーキョー株式会社

#301, 1-4-15, Hiroo, Shibuya-ku, Tokyo 150-0012, Japan

+81 (0)3 6427 5860

inquiry@housserep-tokyo.com

Transaction Type : Intermediate

Agent Fee : 1 month + tax

Website : www.housserep-tokyo.com

