

Property Name	KAMINOGE SAKURA HOUSE	Unit No.	TYPE	Access	Todoroki Station on Oimachi Line (6 min) Kaminoge Station on Oimachi Line (8 min)
		-	House		
Address	2, Nakamachi, Setagaya-Ku, Tokyo				

Cozy 3BR House in Setagaya, near "St.Marry's" & "Seisen" Int'l School

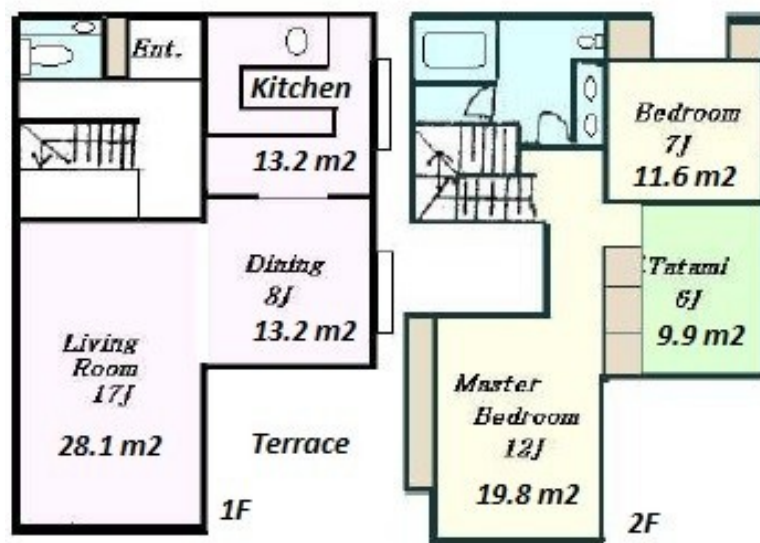
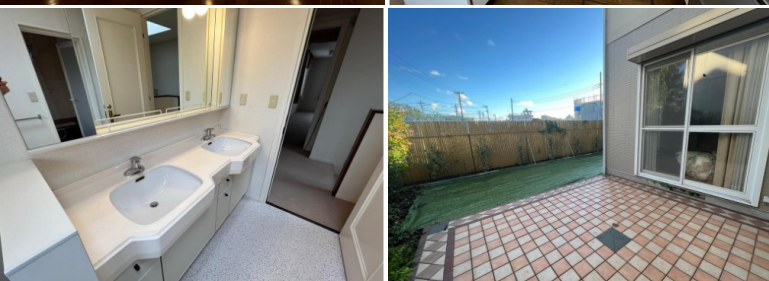

Lease Conditions			
LAYOUT	2 BR+J		
SIZE	14876 m ² /160123.92 ft ²		
RENT	JPY 448,000 / month		
Management Fee	-		
Deposit	2 months	Key Money	1 month
Lease Term	Fixed term lease for 36 months		
Available	Ask for Details		
Renewal Fee	-		
Agent Fee	1 month + tax		
Other Info	Guarantor Company : TBC / Fridge / Air-Con / Separated Toilet / Loft/Maisonnette / Garden/Terrace / Washer / Dryer / Dishwasher / Oven / 2 Toilets		

Building Information			
Completion	Jan, 1993	Earthquake Resistance	New
Structure	Wooden, 2 story		
Car Parking	for 2 spaces (Included)		
Bicycle Parking	N/A		
Music Instrument	-	Pet	N/A
Facilities	Motorcycle Parking (TBC)		

Remarks
Renters Insurance : Required

*The actual Layout & Size may differ slightly from this floor plans & pictures.



HOUSEREP TOKYO INC.

ハウスレップトーキョー株式会社

#301, 1-4-15, Hiroo, Shibuya-ku, Tokyo 150-0012, Japan

+81 (0)3 6427 5860

inquiry@housserep-tokyo.com

Transaction Type : Intermediate

Agent Fee : 1 month + tax

Website : www.housserep-tokyo.com

