

Property Name	KDX RESIDENCE EBISU	Unit No.	TYPE	Access	Ebisu Station on JR Yamanote Line (3 min) Daikanyama Station on Toyoko Line (10 min) Nakameguro Station on Hibiya Line (14 min)
		310	Apt.		
Address	1-11-16, Ebisuminami, Shibuya-Ku, Tokyo				

Modern Stylish Apt. in Ebisu, near Daikanyama / Ebisu Garden Place

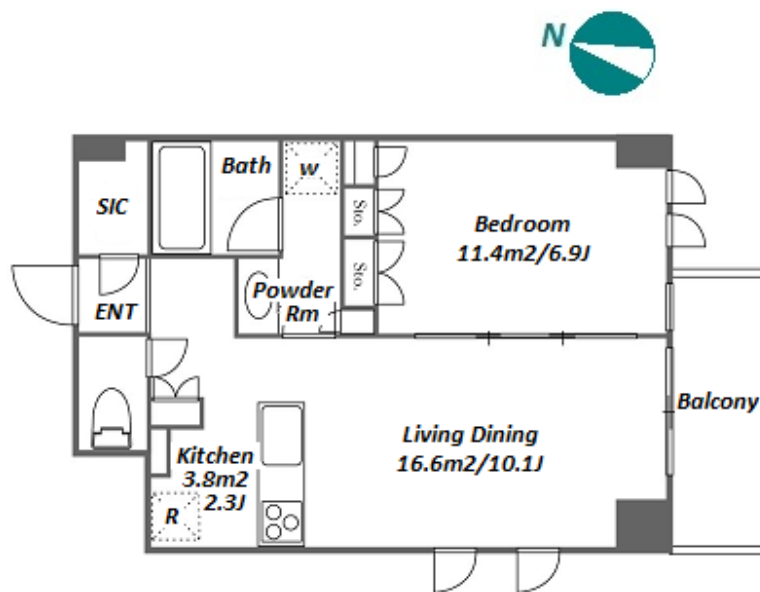
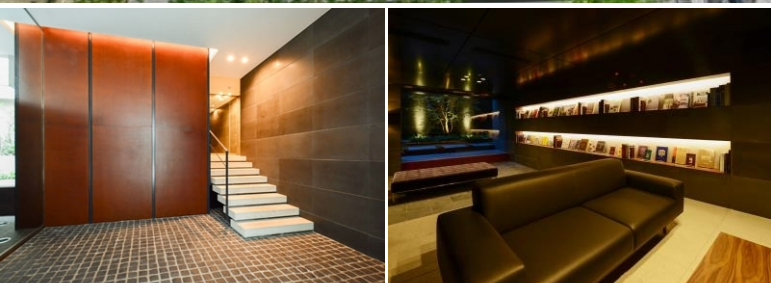

Lease Conditions	
LAYOUT	1 BR
SIZE	49.16 m ² /529.15 ft ²
RENT	JPY 281,000 / month
Management Fee	JPY12,000/month
Deposit	2 months
Key Money	1 month
Lease Term	Standard lease for 24 months
Available	Now
Renewal Fee	1 month
Agent Fee	1 month + tax
Other Info	Key Replacement Fee : JPY18,000 Tax not included / Guarantor Company : TBC / Auto lock / Air-Con / Separated Toilet / Balcony / Internet Included / CS/CATV / Flooring / Floor Heating / Bathroom dryer / Corner Unit

Building Information	
Completion	Oct, 2015
Earthquake Resistance	New
Structure	RC, 8 floors above
Car Parking	TBC
Bicycle Parking	TBC
Music Instrument	-
Pet	N/A
Facilities	Within 20 min to Roppongi by train / Within 20 min to Tokyo station by car / Near Large Parks / Designer's / Delivery box / Elevator / Security / Close to Station

Remarks

*The actual Layout & Size may differ slightly from this floor plans & pictures.



HOUSEREP TOKYO INC.

ハウスレップトーキョー株式会社

#301, 1-4-15, Hiroo, Shibuya-ku, Tokyo 150-0012, Japan

+81 (0)3 6427 5860

inquiry@housserrep-tokyo.com

Transaction Type : Intermediate

Agent Fee : 1 month + tax

Website : www.housserrep-tokyo.com

